



27th ANNUAL CONFERENCE ON GLOBAL ECONOMIC ANALYSIS

Enhancing Global Food System Sustainability



COLORADO STATE UNIVERSITY



Fort Collins, Colorado, USA
June 5-7, 2024

PROGRAM CONTENTS

GENERAL INFORMATION 2
 Location2
 WiFi2
WHOVA MOBILE CONFERENCE APP 3
SPECIAL RECOGNITION 4
 Conference Organizers.....4
 Co-Chairs.....5
 Program Committee.....5
 Abstract Reviewers.....5
 Ken Pearson Travel Funding Award6
 Alex Meeraus / Thomas Rutherford Travel Funding Award7
 Wallace E. Tyner Travel Funding Award8
 GTAP Conference Scholars Program.....9
CONFERENCE VENUE FLOORPLAN 10
TUESDAY, JUNE 4 11
 Schedule11
WEDNESDAY, JUNE 5 12
 Distinguished Plenary Speaker12
 Session Overview13
 Presentation Schedule.....14
THURSDAY, JUNE 6..... 31
 Session Overview31
 Presentation Schedule.....32
FRIDAY, JUNE 7 53
 Distinguished Plenary Speaker53
 Session Overview54
 Presentation Schedule.....55
SATURDAY, JUNE 8..... 72
 Post-Conference Event72
2025 CONFERENCE PREVIEW 73
SESSION PARTICIPANT INDEX..... 74
PARTICIPANT LIST..... 80
GTAP UNIVERSITY (GTAP-U) 87
JOURNAL OF GLOBAL ECONOMIC ANALYSIS..... 88

GENERAL INFORMATION



Location

Colorado State University
Lory Student Center
1101 Center Avenue Mall
Fort Collins, Colorado 80521 USA



Dates

June 5-7, 2024



Time Zone

Mountain Daylight Time
(MDT, UTC-6)



WiFi

csu-visitor

Guests must register to access the csu-visitor wifi using the steps below.

1. Choose "csu-visitor" from the list of available networks
2. A browser will open and take you to the visitor network portal
3. Provide your name and email address in the required fields
4. Accept the university's acceptable use policy
5. Click Register
6. A screen confirming your granted access will be displayed
7. Click Login
8. Access is granted for a 24-hour period that begins at the time of registration. The confirmation screen will display the expiration time for that session. Visitors may re-register as needed.

eduroam

Colorado State University is a participating institution with the eduroam network. Eduroam is a secure, world-wide wireless access service for the international research and education community.

Objective and Format

The goal of the annual conference on economic analysis is to promote the exchange of ideas among economists conducting quantitative analysis of global economic issues. The conference features specially organized and contributed paper breakout sessions. The organized sessions have been developed by members of the GTAP Network to highlight a specific area of research and/or policy analysis. The contributed paper breakout sessions were selected through a peer review process and subsequently grouped to reflect the varied themes being addressed by members of the GTAP Network. The content of these sessions reflects the overall conference themes.

"Enhancing Global Food System Sustainability"

- Agriculture, resource constraints and planetary boundaries
- International trade and supply chains
- Inclusive economic growth
- Food security and nutrition
- Agricultural innovation

Conference papers are available through the conference homepage: www.gtap.org/events/conferences/2024/ ISSN 2160-2115 (online)

Stay Connected with GTAP!

Connect with us on social media and subscribe to the GTAP-L Mailing List to keep up-to-date on all things GTAP!



@GTAP_Purdue



@GTAPPurdue



GTAP



GTAPPurdue



GTAP-L Mailing List

#GTAPConference

WHOVA MOBILE CONFERENCE APP



Whova is the mobile app used to house the conference program, streamline communication during the conference, and facilitate attendee engagement. iOS and Android users can download the free Whova app through their device's app store.

Step 1 – Download Whova App

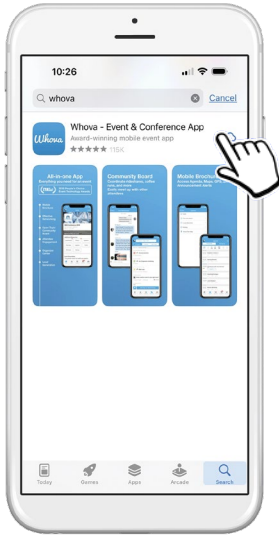

Step 2 – Tap “Find My Event”

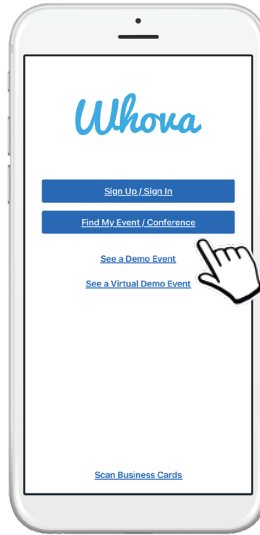

Step 3 – Search for “GTAP”, tap result

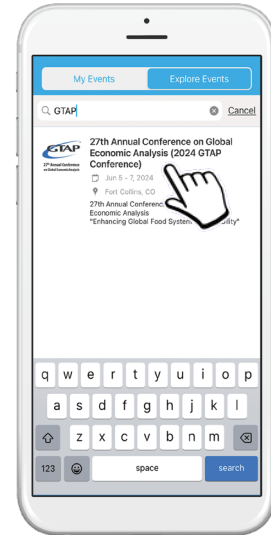

Step 4 – Tap “Join”



Step 5 – Log in using the same email used on your conference registration

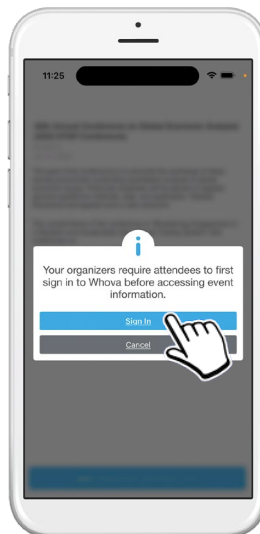

Step 6 – Enjoy the conference!

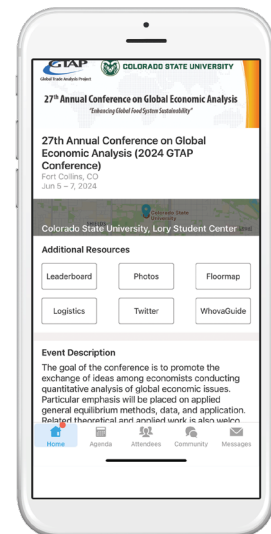

Invitation code:
GTAPConf2024 (if prompted)



Useful Tip

Allow notifications from Whova to ensure you receive schedule updates and other communication during the conference.

SPECIAL RECOGNITION

Conference Organizers



Global Trade Analysis Project

The Global Trade Analysis Project (GTAP) is a global network of researchers and policy makers conducting quantitative analysis of international policy issues within an economy-wide framework. GTAP is coordinated by the Center for Global Trade Analysis, which is housed in the Department of Agricultural Economics at Purdue University. The Center for Global Trade Analysis' mission is to provide leadership in economic policy analysis through better data, fostering collaboration, and research. The centerpiece of Global Trade Analysis Project is the GTAP Data Base, a fully documented and publicly available, analytical data base for the global economy, which contains detailed country data, linked through bilateral trade, transportation and protection. Accompanying this data base is a set of GTAP-based models used and developed by network members. The GTAP Data Base and analytical framework are used by thousands of researchers around the world. Originally, the majority of the research was related to international trade policy issues. Today, GTAP is still the most widely used tool for trade policy, but its use has expanded into poverty, international migration, foreign investment, climate change, environment, energy, and biofuel policies. GTAP has become a common "language" for many of those conducting analysis of global policy issues with GTAP-based results becoming increasingly influential in decision making around the world in trade, climate change, energy and the environment.

www.gtap.agecon.purdue.edu



**COLORADO STATE
UNIVERSITY**

The Colorado State University Department of Agricultural and Resource Economics is a multifaceted group of dedicated scholars solving the world's most wicked challenges like managing the world's food supply and enhancing societal well-being. Their graduates find themselves in the capitol, classroom, board room, on farms, in the forest, and in processing plants where they are changing, influencing, and implementing practical solutions for our food supply and economy. Considering how we make decisions and think about agriculture and natural resources at every level of economics, education, and policy is the Department of Agricultural and Resource Economics' primary contribution to agricultural sciences.

<https://agsci.colostate.edu/dare/>

SPECIAL RECOGNITION

Co-Chairs

- **Dominique van der Mensbrugghe**, Center for Global Trade Analysis, Department of Agricultural Economics, Purdue University
- **Amanda M. Countryman**, Department of Agricultural and Resource Economics, Colorado State University

Program Committee

- | | | | |
|---------------------|-------------------|----------------------|------------------|
| – Channing Arndt | – Antoine Bouët | – Thomas Hertel | – Simon Mevel |
| – Edward Balistreri | – Mary Burfisher | – Kenichi Kawasaki | – William Powers |
| – Eddy Bekkers | – Carmen Estrades | – Maryla Maliszewska | – Anna Strutt |

Abstract Reviewers

- | | | | |
|--------------------------|------------------------------|----------------------------|--------------------------|
| Niango Sika Brice Adou | Emanuele Ferrari | Hebin Lin | Golam Saroare Shakil |
| Angel Aguiar | Joaquim Bento Ferreira-Filho | Jing Liu | Lindsay Shutes |
| Khwaja Muhammad Ahmadzai | Arndt Feuerbacher | Xianglong Locky Liu | Khalid Siddig |
| Parviz Aliev | Gioele Figus | Hans Lofgren | Antti Simola |
| Juergen Amann | Dorothee Flaig | Yingying Lu | Thiago Simonato |
| Alessandro Antimiani | Jean Fouré | Jonas Luckmann | Ganesh Sivamani |
| Karen Arcia | Alan Fox | Helene Maisonnave | Kayaletu Sotsha |
| Tijen Arin | Elizabeth Fraysse | Greenwell Matchaya | Gabriele Standardi |
| Shawn Arita | Rafael Garaffa | Jesús Alberto Mercado | Sascha Suessspeck |
| Sara Ashour | Clara Garcia Bouyssou | Córdova | Jiaze Sun |
| Keerthika B | Alla Golub | Diego Miyajima | David G. Tarr |
| Martin Banse | Christophe Gouel | Abdelradi Mohammed | Karen Thierfelder |
| Heleen Bartelings | Angelo Gurgel | Jongwoo Moon | Karen Thome |
| Nyambaatar Batbayar | Haned Hadjer | Jazib Mumtaz | Sneha Thube |
| Lauren Benavidez | Mussie Mindaye Hailesilassie | Laura Naliaka | Georgios Trachanas |
| Lulit Mitik Beyene | Iman Haqiqi | Jones Odei-Mensah | Trang Tran |
| Rosemary Botha | Nobuhiro Hosoe | Jessica Osanya | Marinos Tsigas |
| Pierre Boulanger | Shih-Hsun Hsu | Yacouba Ouedraogo | Githmi Udagedara |
| Mike Bourne | Lee Humphreys | Luis Pena-Levano | Sharada Vadali |
| Rajesh Chadha | Md. Julfikar Islam | Maria Filipa Seara Pereira | Beatriz Velazquez |
| Jean Chateau | Maros Ivanic | George Philippidis | Adam Walker |
| Maksym Chepeliev | Laerke Jensbye | Amina Qureshi | Zhan Wang |
| Arthur Chopkeng | d'Artis Kancs | Srabashi Ray | Dominic White |
| Alfredo Cisneros-Pineda | Sangita Gayatri Kannan | Lifeng Ren | Rupananda Widanage |
| Teale Cunningham | David Kay | Roberto Roson | Niven Winchester |
| Nfamara K Dampha | Yong-Gun Kim | Jose Manuel Rueda- | Jan Witajewski-Baltvilks |
| Tatjana Döbeling | Thierry Kinkpe | Cantuche | Glyn Wittwer |
| Geoffroy Duparc-Portier | Falk Krumbe | Youssef Salib | Wusheng Yu |
| Kenneth Dy | Jeffrey Kuo | John Saunders | Omid Zamani |
| Ninke Feenstra | Elisa Lanzi | Florian Schiffmann | Qishi Zhang |
| | Shantong Li | Saloni Shah | Bhekani Zondo |

SPECIAL RECOGNITION

Ken Pearson Travel Funding Award

In recognition of the many contributions made by the late Professor Ken Pearson to the GTAP Network, the **Centre of Policy Studies, Victoria University** has provided funding in his name aimed to support the participation of promising young researchers at the GTAP Conference and encourage their contribution to the use and further development of analytical software for CGE modelling, following in his tradition. Recipient(s) were selected based on the following criteria: 1) an early career researcher within five years of the start of their research career; 2) active in undertaking applied model-based analyses of real-world problems using GEMPACK or related software; and 3) paper accepted into the GTAP Conference.



Ken Pearson's early career was as an outstanding mathematician. In the 1970s, he became Reader and Chairman in Mathematics at La Trobe University, Australia. In his teaching role, he investigated the possibility of drawing on economics rather than physics for relevant examples. In this process, he came across the newly emerging field of applied (or computable) general equilibrium modelling. Long before the economists, Ken recognized the need for software that would not only solve large scale economic models but would also be a vehicle: for organizing data; for analyzing results; for transferring models between researchers; and for storing models in a computationally accessible fowhich would allow them to be accessed at other times and by other researchers. By the mid-1980s, he had responded to this need by taking up a visiting position at the Impact Research Centre (Melbourne University) and creating GEMPACK. In 1992, Ken moved to the Centre of Policy Studies (CoPS, then located at Monash University). At CoPS, he was appointed Professorial Fellow

in 1999, and held the position of Deputy Director from 2000 to 2004. He retired in 2014, with the position of Director, GEMPACK passing to Mark Horridge. Ken died of cancer on May 12, 2015. Throughout his illness, he was stoic, always cheerful, and grateful for a good life. In a summary of Ken's contribution to the GTAP, Tom Hertel wrote, *"Those of us who had the privilege of working closely with Ken count our collaborations with him as among the most stimulating and rewarding of our careers. Ken's keen intellect and his background in theoretical mathematics allowed him to quickly grasp the essence of whatever modeling challenge we posed."*

Recipient**Rayan Wolf**

Professor, Universidade Estadual de Mato Grosso do Sul (Brazil)

Assessing the impacts of workforce skill improvement on income transfer programme beneficiaries in Brazil (#7184)

Session #30, Pg. 45

Rayan holds a Ph.D. in Applied Economics from the Federal University of Viçosa (UFV), having received a scholarship from the National Council for Scientific and Technological Development (CNPq). During his doctoral period, he was a visiting foreign researcher at the Centre of Policy Studies (CoPS), supported by a scholarship from the Coordination for the Improvement of Higher Education Personnel (CAPES). Rayan possesses expertise in the treatment and processing of microdata in Brazilian databases (POF, PNAD), as well as in the construction of input-output matrices and the development of computable general equilibrium models, and fulfills key roles as a coordinator, researcher, and data contributor for the Brazilian Economy General Equilibrium Analysis Project (PAEG). Rayan developed the DAYANE model, an analytical general equilibrium model for the Brazilian economy using GEMPACK, featuring a disaggregated labor market across Brazilian macro-regions. Additionally, he developed the PAEG-Cerrado model, a general equilibrium model for the Brazilian economy using GAMS, which disaggregates the Cerrado region and allows for the analysis of Co2 emissions and land use issues. He is actively involved in research on mathematical methods in economics, focusing on computable general equilibrium models, demonstrating expertise in management and analysis of economic data.

SPECIAL RECOGNITION

Alex Meeraus / Thomas Rutherford Travel Funding Award

In recognition of Meeraus and Rutherford's contributions, the **GAMS Development Corporation** has provided funding in their names aimed to support the participation of promising young researchers at the GTAP Conference and encourage their contribution to the use and further development of analytical software for CGE modelling. Recipient(s) were selected based on being the following criteria: 1) an early career researcher within five years of the start of their research career; 2) active in undertaking applied model-based analyses using GAMS or related software; and 3) paper accepted into the GTAP Conference.



Alexander Meeraus is the founder and CEO Emeritus of the GAMS Development Corporation, a high-tech international development and consulting firm in the area of strategic and operation planning systems and software applied to problems in industry, government and academia. After finishing his studies in mechanical engineering at the Technical University in

Vienna, he came to the US, worked for General Electric in the development of engineering software for computer aided design and joined the World Bank's Development Research Center in 1972. His research focused at investment planning in the process industries, agriculture and water resources. He led the development team for the General Algebraic Modeling System (GAMS), now widely used around the world for strategic and operational planning and scheduling. In 1987, he left the Bank to fully develop the GAMS software into a commercially viable product. In 1988 he was awarded the INFORMS Computing Society Prize for the development of GAMS. In the Celebrating 50 Years of Operations Research festschrift, GAMS was selected as the 1988 milestone. In 2012, GAMS shared the INFORMS Impact Prize for the development of Algebraic Modeling Systems.

Thomas Rutherford received his Ph.D. in operations research from Stanford in 1987 and is currently a Professor of Agricultural and Applied Economics at the University of Wisconsin-Madison. Rutherford has had a career arc that has touched the most challenging global policy issues of our times—trade, energy markets, and climate change. He has combined his keen interest in economic policy making while advancing the frontiers of economic modeling in spatial, industrial, mathematical and dynamic economics. Another component of Tom's portfolio is the development of algorithms and software that has led to major improvements in quantitative tools that facilitate the ability to undertake policy analysis. The best known of these tools is the Mathematical Programming System for General Equilibrium (MPSGE), a modeling environment designed to facilitate the development of GE models that is combined with the General Algebraic Modeling System (GAMS). He developed a global model in MPSGE coupled to the GTAP Data Base (known as GTAPinGAMS) that has been widely used and lowered the entry cost to global economic modeling for GAMS users.

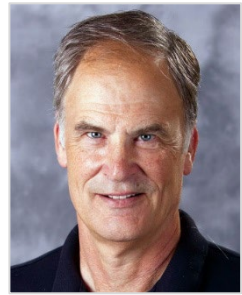
**Recipient****Debbara Leip**

PhD Student, Potsdam Institute for Climate Impact Research (Germany)

Future Employment in Global Agriculture: Trends and Drivers in the Shared Socioeconomic Pathways (#7198)

Session #36, Pg. 51

Debbara Leip is a Ph.D. student at the Potsdam Institute for Climate Impact Research in Germany, where she is part of the Land-Use Management working group, further developing and applying the agro-economic partial equilibrium model MAGPIE (Model of Agricultural Production and its Impact on the Environment). She has a background in Mathematics and Environmental Modelling, which she graduated with a M.Sc. thesis on "Risk management for sustainable food security in West Africa". Over the past years, Debbara has contributed to the Food System Economics Commission (FSEC) as a member of the FSEC-Secretariat and the core-modelling team. In January 2023, she started her Ph.D. research on "Agricultural employment in a sustainable transformation of the global food system".

SPECIAL RECOGNITION

Wallace E. Tyner Travel Funding Award

In recognition of the late Professor Wallace E. Tyner, who served as Senior Policy Advisor to the Center for Global Trade Analysis for many years and was a strong proponent for establishing the center at Purdue University in the early 1990s, the Center for Global Trade Analysis has provided funding in his name to support the participation of a promising young researcher at the annual GTAP conference. Recipient(s) were selected based on the following criteria: 1) an early career researcher undertaking policy-relevant, research at the interface of the economy, energy and the environment with preference given to research that bridges disciplinary boundaries; and 2) paper accepted into the GTAP Conference.



Global Trade Analysis Project

Center for Global Trade Analysis
Department of Agricultural Economics
Purdue University



Professor Tyner's research interests were broad, but centered mostly in the areas of climate, energy, agricultural, and natural resource policy analysis. His work in energy economics encompassed oil, natural gas, coal, oil shale, biomass, biofuels from agricultural sources, and solar and wind energy. Much of work focused on economic and policy analysis for biofuels and the interplay between biofuels policies and other energy policies. As Department Head of Purdue's Department of Agricultural Economics from 1989-2002, Wally oversaw the establishment of the Center for Global Trade Analysis and facilitated the formation of the GTAP Consortium – a key ingredient in GTAP's longevity. When he returned to the faculty in 2003, Wally initiated a cutting-edge program of research related to biofuels and their linkages to energy, agriculture and the environment. In this context, he became a heavy user of the GTAP Model and its derivatives: GTAP-AEZ and GTAP-BIO. His research in this area earned him lifetime career recognitions from his

professional associations (AAEA, AAAS and IAEE), industry (US Association for Energy Economics), as well as from Purdue University (the Morrill Award for outstanding career achievements with a societal impact), among many other awards. Wally was a great role model and advocate for policy-relevant, inter-disciplinary research. He was also an excellent mentor for students and young professionals.

Recipient**Wei Xiang**

PhD Student, Yale University (United States)

Clean Growth and Environmental Policies in the Global Economy (#7147)

Organized Session #48, Pg. 66

Wei Xiang got his PhD in economics from Yale. His research focuses on economic growth, international trade, and environmental policies, with his most current project exploring how environmental regulation shapes the global distribution of production and clean growth. He has been doing policy research for international organizations such as the Asian Development Bank and the World Bank in the past three years. His research has been recognized by awards and grants, including the Arvid Anderson Fellowship and the Sylff Fellowship.

SPECIAL RECOGNITION

GTAP Conference Scholars Program

The goal of the GTAP Conference Scholars Program is to provide first-time student presenters the opportunity to dry-run their presentation in a virtual environment prior to the conference, receive feedback, and have time to reflect on, and incorporate changes before their conference presentation.

Participants



Chandni Dawani, PhD Scholar, International College for Girls, The IIS University (India)

Unlocking India's Export Opportunities in ASEAN: Insights from GTAP Model and Viner's Trade Creation

Methodology (#7242)

Session #4, Pg. 18



Sionegael Ikeme, Ph.D Student, Colorado State University, Department of Agricultural and Resource Economics (United States)

WTO vs. TRAINS: A quantitative comparison of time-varying ad-valorem equivalents for non-tariff trade

measures (#7252)

Session #4, Pg. 18



Mustajab Khatir, Ph.D Student, Birla Institute of Technology and Sciences - Hyderabad Campus (India)

An Ex-Ante Evaluation of Deeper Integration among South Asia and Southeast Asia: A General Equilibrium

Analysis (#7353)

Session #39, Pg. 57



Jessica Osanya, Ph.D Student, Oregon State University (United States)

Economywide Impacts of the Supplemental Nutrition Assistance Program (#7216)

Session #26, Pg. 41



Ming Wang, Ph.D Student, Colorado State University, Department of Agricultural and Resource Economics (United States)

U.S. Agricultural Conservation Policy Effects on Global Agricultural Markets: Evidence from The Conservation

Reserve Program (#7254)

Session #24, Pg. 39



Alex Watkins, Ph.D Student, University of Queensland (Australia)

The global impact of national environmental commitments (#7333)

Session #26, Pg. 41

CONFERENCE VENUE FLOORPLAN

Lory Student Center
300 Level (3rd Floor)

Breaks, Lunches,
Reception, Dinner

Plenary Sessions

Grand Ballrooms

Registration Desk
(Lobby)

Breakout Rooms

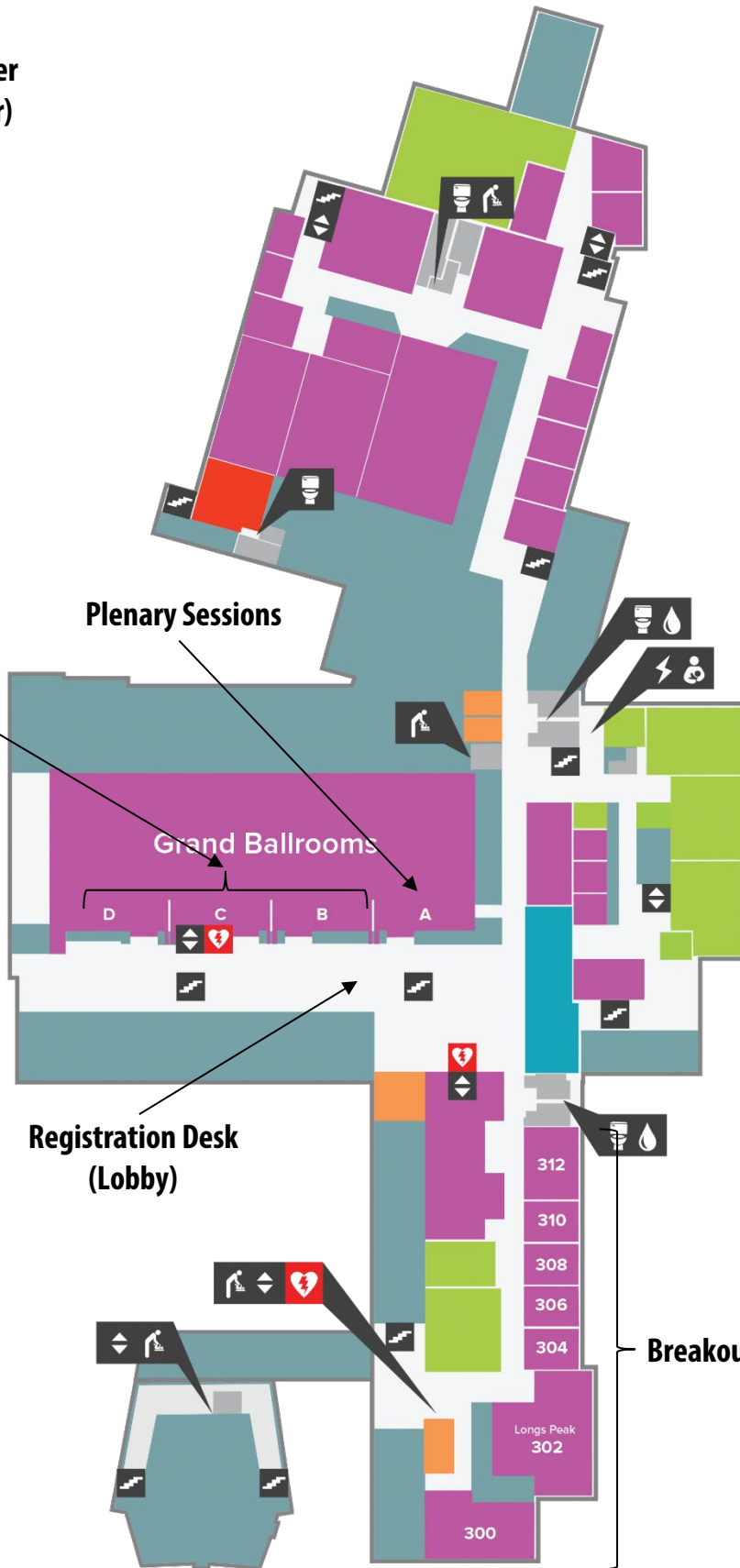

TUESDAY, JUNE 4

Schedule

Time (MDT, UTC-6)	Event	Location
3:00-5:00pm	Early Onsite Check-in	3rd Floor Lobby

We encourage participants who will be in Fort Collins on Tuesday afternoon to attend this early check-in to collect their conference materials and avoid the lines Wednesday morning.

Colorado State University

Lory Student Center, 3rd Floor Main Lobby

1101 Center Avenue Mall

Fort Collins, Colorado 80521 USA

WEDNESDAY, JUNE 5

Distinguished Plenary Speaker

Embedding Climate Change in Macroeconomic Analysis for Research and Policy



Fran Moore

Associate Professor

Department of Environmental Science and Policy, University of California Davis

<https://franmoore.faculty.ucdavis.edu/>

Fran Moore is an Associate Professor in the Department of Environmental Science and Policy at UC Davis, working at the intersection of environmental economics and climate science. Her research seeks to improve our understanding of the economic and social impacts of climate change and to better understand our ability to adapt to those impacts. To do this, she combines econometric analysis, experimental approaches, climate model output, and economic modeling. She currently also serves as the Hurlstone Presidential Chair in the Department of

Environmental Science and Policy.

ANNUAL CONFERENCE ON GLOBAL ECONOMIC ANALYSIS

WEDNESDAY, JUNE 5

Session Overview

Session details for this day are listed on pages 14-30. You can also access the conference schedule through the **Whova** mobile app (see page 3).

MDT (UTC-6)	Session	Location
9:00-10:20am	Opening Remarks and Plenary Session - Pg. 14 <i>Embedding Climate Change in Macroeconomic Analysis for Research and Policy</i>	Ballroom A
10:20-10:50am	Coffee Break	Ballroom B/C/D
10:50am-12:35pm	Organized Session #1 - Pg. 15 <i>Introducing Spatial Heterogeneity in the Analysis of Local and Global Policies using Equilibrium Models</i>	300
	Organized Session #2 - Pg. 16 <i>Enhancing representation of blue economy in the computable general equilibrium models</i>	302 (Longs Peak)
	Session #3 - Pg. 17 <i>Climate Change Policy</i>	304
	Session #4 - Pg. 18 <i>Non-Tariff Measures and Preferential Trading Arrangements</i>	306
	Session #5 - Pg. 19 <i>African Trade and Investment Modeling</i>	308
12:35-1:50pm	Lunch	Ballroom B/C/D
1:50-4:00pm	Session #6 - Pg. 20 <i>Water Use and Pollution Policies/Impacts</i>	300
	Organized Session #7 - Pg. 21 <i>Advances in modeling global food and agricultural systems</i>	302 (Longs Peak)
	Session #8 - Pg. 22 <i>Methods for Data Exploration</i>	304
	Session #9 - Pg. 23 <i>Non-Tariff Barriers and Measures</i>	306
	Session #10 - Pg. 24 <i>Ecosystem, Land Use, and Environmental Policies</i>	308
	Session #11 - Pg. 25 <i>Approaches to Modeling Trade</i>	312
4:00-4:30pm	Coffee Break	Ballroom B/C/D
4:30-6:15pm	Organized Session #12 - Pg. 26 <i>Modeling Household Diet Quality in CGE Models</i>	300
	Organized Session #13 - Pg. 27 <i>Bridging Generations: The 1st Symposium for Aspiring Scholars and CGE Modeling Pioneers</i>	302 (Longs Peak)
	Session #14 - Pg. 28 <i>Global Value Chains and Decoupling</i>	304
	Session #15 - Pg. 29 <i>Climate Policy and Impacts</i>	306
	Session #16 - Pg. 30 <i>Agricultural and Sustainability Policies</i>	308
6:15-8:45pm	Reception	Ballroom B/C/D

WEDNESDAY, JUNE 5**Presentation Schedule**

Presenters should arrive to their assigned session room 10 minutes prior to the start of the session with their presentation on a USB drive in both PowerPoint and PDF formats. Times listed within each session are targets and may vary slightly.

**Looking for a paper?**

Search by ID# at: <http://www.gtap.org/events/conferences/2024/>

Time (MDT, UTC-6)	Event	Location
8:00am-5:00pm	Onsite Check-in	3rd Floor Lobby
9:00-10:20am	Opening Remarks and Plenary Session	Ballroom A
<i>Embedding Climate Change in Macroeconomic Analysis for Research and Policy</i>		
Session Chair:	Andrew Schreiber , US Environmental Protection Agency (EPA)	
9:00-9:30am	Opening Remarks <ul style="list-style-type: none"> – Dominique van der Mensbrugge, Center for Global Trade Analysis, Department of Agricultural Economics, Purdue University – Amanda M. Countryman, Department of Agricultural and Resource Economics, Colorado State University 	
9:30-9:35am	Session Introduction	
9:35-9:55am	Embedding Climate Change in Macroeconomic Analysis for Research and Policy <ul style="list-style-type: none"> – Fran Moore, University of California Davis 	
9:55-10:15am	Discussion	
10:15-10:20am	Session Closing	
10:20-10:50am	Coffee Break	Ballroom B/C/D

WEDNESDAY, JUNE 5

Presentation Schedule

Presenters should arrive to their assigned session room 10 minutes prior to the start of the session with their presentation on a USB drive in both PowerPoint and PDF formats. Times listed within each session are targets and may vary slightly.

**Looking for a paper?**

Search by ID# at: <http://www.gtap.org/events/conferences/2024/>

Time (MDT, UTC-6)	Event	Location
10:50am-12:35pm	Organized Session #1	300

Introducing Spatial Heterogeneity in the Analysis of Local and Global Policies using Equilibrium Models

Organized by: Srabashi Ray, Center for Global Trade Analysis, Department of Agricultural Economics, Purdue University

Session Chair: Channing Arndt, International Food Policy Research Institute / CGIAR

10:50-10:53am	Session Introduction
10:53-11:08am	<p><u>Understanding Effectiveness and Equity of Conservation Policies using Economic Theory</u> (#7215)</p> <ul style="list-style-type: none"> – Srabashi Ray, Center for Global Trade Analysis, Department of Agricultural Economics, Purdue University
11:08-11:18am	Discussion
11:18-11:33am	<p><u>Implications of the 30x30 biodiversity conservation targets: quantifying uncertainty in local and global food system projections</u> (#7323)</p> <ul style="list-style-type: none"> – Iman Haqiqi, Center for Global Trade Analysis, Department of Agricultural Economics, Purdue University
11:33-11:43am	Discussion
11:43-11:58am	<p><u>GTAP-SIMPLEG: An Integrated Model for Coupling Gridded Land Use, Crop Production and Environment Impacts with Global Supply Chain and Bilateral Trade System</u> (#7271)</p> <ul style="list-style-type: none"> – Zhan Wang, Center for Global Trade Analysis, Department of Agricultural Economics, Purdue University
11:58am-12:08pm	Discussion
12:08-12:23pm	<p><u>Conservation benefits from retiring land in neighboring locations offset welfare costs</u> (#7344)</p> <ul style="list-style-type: none"> – Alfredo Cisneros-Pineda, Center for Global Trade Analysis, Department of Agricultural Economics, Purdue University
12:23-12:33pm	Discussion
12:33-12:35pm	Session Closing

WEDNESDAY, JUNE 5

Presentation Schedule

Presenters should arrive to their assigned session room 10 minutes prior to the start of the session with their presentation on a USB drive in both PowerPoint and PDF formats. Times listed within each session are targets and may vary slightly.

**Looking for a paper?**

Search by ID# at: <http://www.gtap.org/events/conferences/2024/>

Time (MDT, UTC-6)	Event	Location
10:50am-12:10pm	Organized Session #2	302 (Longs Peak)

Enhancing representation of blue economy in the computable general equilibrium models

Organized by: Maksym Chepeliev, Center for Global Trade Analysis, Department of Agricultural Economics, Purdue University

Byeong-ho Lim, Korea Maritime Institute

Session Chair: Maksym Chepeliev, Center for Global Trade Analysis, Department of Agricultural Economics, Purdue University

10:50-10:53am Session Introduction

10:53-11:08am **Enhanced Disaggregation of the Fishery Sector for Policy Simulation in CGE Models** (#7245)

– Byeong-ho Lim, Korea Maritime Institute

11:08-11:18am Discussion

11:18-11:33am **Beyond Tariffs: Assessing the Global Trade Impact of Fisheries Production Limits** (#7157)

– Jeongho Yoo, Pukyong National University

11:33-11:43am Discussion

11:43-11:58am **Blue economy with a CGE framework: an analysis of the possible role of seafood within sustainable diets** (#7202)

– Heleen Bartelings, Wageningen Economic Research

11:58am-12:08pm Discussion

12:08-12:10pm Session Closing

WEDNESDAY, JUNE 5**Presentation Schedule**

Presenters should arrive to their assigned session room 10 minutes prior to the start of the session with their presentation on a USB drive in both PowerPoint and PDF formats. Times listed within each session are targets and may vary slightly.

**Looking for a paper?**

Search by ID# at: <http://www.gtap.org/events/conferences/2024/>

Time (MDT, UTC-6)	Event	Location
10:50am-12:35pm	Session #3	304

Climate Change Policy

Session Chair: Shih-Hsun Hsu, National Taiwan University

10:50-10:53am Session Introduction

10:53-11:08am **Assessing global and sub-global socioeconomic transition uncertainty for climate management and risk analyses** (#7205)

– Jennifer Morris, MIT

11:08-11:18am Discussion

11:18-11:33am **An Analysis for Carbon Constraint Modeling** (#7185)

– Y.-H. Henry Chen, MIT Joint Program on the Science and Policy of Global Change

11:33-11:43am Discussion

11:43-11:58am **An integrated assessment of provincial economic damages from climate change in China** (#7194)

– Hantang Peng, Tsinghua University

11:58am-12:08pm Discussion

12:08-12:23pm **Measuring the Impact of Climate Change on Agricultural Revenue: A Climate Stress Testing at the County Level** (#7204)

– Alma Cortes Selva, BMO

12:23-12:33pm Discussion

12:33-12:35pm Session Closing

WEDNESDAY, JUNE 5

Presentation Schedule

Presenters should arrive to their assigned session room 10 minutes prior to the start of the session with their presentation on a USB drive in both PowerPoint and PDF formats. Times listed within each session are targets and may vary slightly.

**Looking for a paper?**

Search by ID# at: <http://www.gtap.org/events/conferences/2024/>

Time (MDT, UTC-6)	Event	Location
10:50am-12:35pm	Session #4	306

Non-Tariff Measures and Preferential Trading Arrangements

Session Chair: George Philippidis, CITA, Government of Aragón

10:50-10:53am	Session Introduction
10:53-11:08am	<p><u>WTO vs. TRAINS: A quantitative comparison of time-varying ad-valorem equivalents for non-tariff trade measures</u> (#7252)</p> <ul style="list-style-type: none"> – Sionegael Ikeme, Colorado State University *GTAP Conference Scholars Program Participant
11:08-11:18am	Discussion
11:18-11:33am	<p><u>Sustainability impacts of digital trade policies in the Asia-Pacific</u> (#7339)</p> <ul style="list-style-type: none"> – Anna Strutt, University of Waikato
11:33-11:43am	Discussion
11:43-11:58am	<p><u>Economic Effects of Services Trade Liberalization within the RCEP in the Presence of Heterogeneous Trade Costs</u> (#7154)</p> <ul style="list-style-type: none"> – Xiaomei Wang, Shandong University
11:58am-12:08pm	Discussion
12:08-12:23pm	<p><u>Unlocking India's Export Opportunities in ASEAN: Insights from GTAP Model and Viner's Trade Creation Methodology</u> (#7242)</p> <ul style="list-style-type: none"> – Chandni Dawani, International College for Girls, The IIS University *GTAP Conference Scholars Program Participant
12:23-12:33pm	Discussion
12:33-12:35pm	Session Closing

WEDNESDAY, JUNE 5**Presentation Schedule**

Presenters should arrive to their assigned session room 10 minutes prior to the start of the session with their presentation on a USB drive in both PowerPoint and PDF formats. Times listed within each session are targets and may vary slightly.

**Looking for a paper?**

Search by ID# at: <http://www.gtap.org/events/conferences/2024/>

Time (MDT, UTC-6)	Event	Location
10:50am-12:35pm	Session #5	308

African Trade and Investment Modeling

Session Chair: Simon Mevel, United Nations Economic Commission for Africa

10:50-10:53am

Session Introduction

10:53-11:08am

The Impact of African Continental Free Trade Area (AfCFTA) Implementation on Ethiopian Economy (#7177)

– **Mussie Mindaye Hailesilassie**, Messina University

11:08-11:18am

Discussion

11:18-11:33am

Moving from the African Continental Free Trade Area to an African Custom Union: A computable general equilibrium assessment (#7324)

– **Leysa Maty Sall**, Bordeaux School of Economics and CEPII

11:33-11:43am

Discussion

11:43-11:58am

In Gravity no Veritas? Dubious Trade Elasticity and Weak Effects of Regional Trade Agreements in Africa (#7138)

– **Geoffroy Guepie**, Economic Commission for Africa

11:58am-12:08pm

Discussion

12:08-12:23pm

Public investments in infrastructure and economic growth in Morocco: dynamic EGC modeling (#7217)

– **Ayoub Kharbouche**, Mohammed V University in Rabat

12:23-12:33pm

Discussion

12:33-12:35pm

Session Closing

12:35-1:50pm	Lunch	Ballroom B/C/D
--------------	-------	----------------

WEDNESDAY, JUNE 5

Presentation Schedule

Presenters should arrive to their assigned session room 10 minutes prior to the start of the session with their presentation on a USB drive in both PowerPoint and PDF formats. Times listed within each session are targets and may vary slightly.

**Looking for a paper?**

Search by ID# at: <http://www.gtap.org/events/conferences/2024/>

Time (MDT, UTC-6)	Event	Location
1:50-3:35pm	Session #6	300

Water Use and Pollution Policies/Impacts

Session Chair: Iman Haqiqi, Center for Global Trade Analysis, Department of Agricultural Economics, Purdue University

1:50-1:53pm Session Introduction

1:53-2:08pm **Irrigation Policy: Water Use and Socioeconomic Contributions in Brazil** (#7145)

– Angel dos Santos Fachinelli Ferrarini, Federal University of Rondonopolis

2:08-2:18pm Discussion

2:18-2:33pm **Nonpoint Source Pollution Mitigation Through Tax under Climate Change** (#7149)

– Jing Liu, Center for Global Trade Analysis, Department of Agricultural Economics, Purdue University

2:33-2:43pm Discussion

2:43-2:58pm **Climate change, biodiversity, and pollution: Modelling the interlinkages in drivers, impacts, and policies** (#7244)

– Toon Vandyck, OECD

2:58-3:08pm Discussion

3:08-3:23pm **Valuing Air Pollution's Impact on Labor Productivity in General Equilibrium** (#7203)

– Andrew Schreiber, US Environmental Protection Agency (EPA)

3:23-3:33pm Discussion

3:33-3:35pm Session Closing

WEDNESDAY, JUNE 5

Presentation Schedule

Presenters should arrive to their assigned session room 10 minutes prior to the start of the session with their presentation on a USB drive in both PowerPoint and PDF formats. Times listed within each session are targets and may vary slightly.

**Looking for a paper?**

Search by ID# at: <http://www.gtap.org/events/conferences/2024/>

Time (MDT, UTC-6)	Event	Location
1:50-3:35pm	Organized Session #7	302 (Longs Peak)

Advances in modeling global food and agricultural systems

Organized by: Maksym Chepeliev, Center for Global Trade Analysis, Department of Agricultural Economics, Purdue University
Session Chair: Maksym Chepeliev, Center for Global Trade Analysis, Department of Agricultural Economics, Purdue University

1:50-1:53pm	Session Introduction
1:53-2:08pm	<u>Compiling Food Balance Sheet using detailed FAO Supply Utilization Accounting data to improve the understanding and modeling of the food system</u> (#7175) – Xin Zhao, Joint Global Change Research Institute, PNNL
2:08-2:18pm	Discussion
2:18-2:33pm	<u>Global food loss and waste estimates show increasing nutritional and environmental pressures</u> (#7151) – Alessandro Gatto, Wageningen University and Research
2:33-2:43pm	Discussion
2:43-2:58pm	<u>Spatial Allocation of Agricultural Production: IFPRI's latest SPAM2020</u> (#7240) – Liangzhi You, International Food Policy Research Institute
2:58-3:08pm	Discussion
3:08-3:23pm	<u>Scenarios of Global Food Consumption: Implications for Agriculture</u> (#7322) – Ronald Sands, USDA Economic Research Service
3:23-3:33pm	Discussion
3:33-3:35pm	Session Closing

WEDNESDAY, JUNE 5**Presentation Schedule**

Presenters should arrive to their assigned session room 10 minutes prior to the start of the session with their presentation on a USB drive in both PowerPoint and PDF formats. Times listed within each session are targets and may vary slightly.

**Looking for a paper?**

Search by ID# at: <http://www.gtap.org/events/conferences/2024/>

Time (MDT, UTC-6)	Event	Location
1:50-4:00pm	Session #8	304

Methods for Data Exploration

Session Chair: Angel Aguiar, Center for Global Trade Analysis, Department of Agricultural Economics, Purdue University

1:50-1:53pm	Session Introduction
1:53-2:08pm	<u>Using Howler to check GTAP databases for anomalies</u> (#7135) – Glyn Wittwer, Centre of Policy Studies
2:08-2:18pm	Discussion
2:18-2:33pm	<u>Python Agg for GTAP</u> (#7206) – Peter Minor, ImpactECON
2:33-2:43pm	Discussion
2:43-2:58pm	<u>Exploring Aggregation Bias in General Equilibrium Models: A Comparison of Elasticity Aggregation Formulas Using Real-World Data</u> (#7201) – Yong-Gun Kim, Yonsei University
2:58-3:08pm	Discussion
3:08-3:23pm	<u>An Information Theoretic Approach to Estimating Matrices of Economic Data</u> (#7210) – Sherman Robinson, International Food Policy Research Institute (IFPRI)
3:23-3:33pm	Discussion
3:33-3:48pm	<u>Estimating Elasticities for Tradable Services in Policy Simulations</u> (#7307) – Saad Ahmad, US International Trade Commission
3:48-3:58pm	Discussion
3:58-4:00pm	Session Closing

WEDNESDAY, JUNE 5**Presentation Schedule**

Presenters should arrive to their assigned session room 10 minutes prior to the start of the session with their presentation on a USB drive in both PowerPoint and PDF formats. Times listed within each session are targets and may vary slightly.

**Looking for a paper?**

Search by ID# at: <http://www.gtap.org/events/conferences/2024/>

Time (MDT, UTC-6)	Event	Location
1:50-3:10pm	Session #9	306

Non-Tariff Barriers and Measures

Session Chair: Natalie Soroka, International Trade Administration

1:50-1:53pm Session Introduction

1:53-2:08pm **Investment Facilitation for Development Agreement: Potential Gains** (#7136)

– Zoryana Olekseyuk, German Institute of Development and Sustainability

2:08-2:18pm Discussion

2:18-2:33pm **The medley of quotas between the EU and New Zealand (and how to model them in GTAP)** (#7209)

– Tatjana Döbeling, Thünen-Institut

2:33-2:43pm Discussion

2:43-2:58pm **Structural Estimation of the Effects of Technical Non-Tariff Measures** (#7352)

– Achim Vogt, World Trade Institute, University Bern

2:58-3:08pm Discussion

3:08-3:10pm Session Closing

WEDNESDAY, JUNE 5

Presentation Schedule

Presenters should arrive to their assigned session room 10 minutes prior to the start of the session with their presentation on a USB drive in both PowerPoint and PDF formats. Times listed within each session are targets and may vary slightly.

**Looking for a paper?**

Search by ID# at: <http://www.gtap.org/events/conferences/2024/>

Time (MDT, UTC-6)	Event	Location
1:50-4:00pm	Session #10	308

Ecosystem, Land Use, and Environmental Policies

Session Chair: Gessica Souza, National School of Public Administration - ENAP

1:50-1:53pm	Session Introduction
1:53-2:08pm	<u>Wild pigs (<i>Sus scrofa</i>) population management in Brazil: mitigating crop damages</u> (#7167) – Giovani William Gianetti , Escola Superior de Agricultura Luiz de Queiroz, Universidade de Sao Paulo
2:08-2:18pm	Discussion
2:18-2:33pm	<u>Trade Agreements, Import Bans, & the Leverage of the EU on Reducing Deforestation in Brazil</u> (#7176) – Nelson B. Villoria , Department of Agricultural Economics
2:33-2:43pm	Discussion
2:43-2:58pm	<u>Unbalanced productivity growth and deforestation: a macroeconomic perspective in Brazil's Legal Amazon</u> (#7234) – Joaquim Bento Ferreira-Filho , Escola Superior de Agricultura Luiz de Queiroz
2:58-3:08pm	Discussion
3:08-3:23pm	<u>Global Land Cover Changes under Changing Climate and Socioeconomic Conditions from 2001-2020</u> (#7270) – Shuo Chen , Purdue University
3:23-3:33pm	Discussion
3:33-3:48pm	<u>Assessing induced economic and environmental impacts of biofuels and their consequential life-cycle analyses in a computable general equilibrium framework: An exercise with GTAP-BIO model</u> (#7262) – Farzad Taheripour , Department of Agricultural Economics, Purdue University
3:48-3:58pm	Discussion
3:58-4:00pm	Session Closing

WEDNESDAY, JUNE 5**Presentation Schedule**

Presenters should arrive to their assigned session room 10 minutes prior to the start of the session with their presentation on a USB drive in both PowerPoint and PDF formats. Times listed within each session are targets and may vary slightly.

**Looking for a paper?**

Search by ID# at: <http://www.gtap.org/events/conferences/2024/>

Time (MDT, UTC-6)	Event	Location
1:50-3:10pm	Session #11	312

Approaches to Modeling Trade

Session Chair: Christine Arriola, OECD

1:50-1:53pm Session Introduction

1:53-2:08pm **Shocks in a highly interlinked global economy** (#7197)
 – Przemyslaw Kowalski, Organisation for Economic Co-operation and Development

2:08-2:18pm Discussion

2:18-2:33pm **A Heterodox Approach to Heterogeneous Firms Exploiting Complementarity and Karush-Kuhn-Tucker** (#7137)
 – James Markusen, University of Colorado, Boulder

2:33-2:43pm Discussion

2:43-2:58pm **Small group monopolistic competition in a GTAP model: meeting the Markusen challenge** (#7257)
 – Peter Dixon, Victoria University

2:58-3:08pm Discussion

3:08-3:10pm Session Closing

4:00-4:30pm	Coffee Break	Ballroom B/C/D
-------------	--------------	----------------

WEDNESDAY, JUNE 5

Presentation Schedule

Presenters should arrive to their assigned session room 10 minutes prior to the start of the session with their presentation on a USB drive in both PowerPoint and PDF formats. Times listed within each session are targets and may vary slightly.

**Looking for a paper?**

Search by ID# at: <http://www.gtap.org/events/conferences/2024/>

Time (MDT, UTC-6)	Event	Location
4:30-5:50pm	Organized Session #12	300

Modeling Household Diet Quality in CGE Models

Organized by: James Thurlow, International Food Policy Research Institute

Session Chair: James Thurlow, International Food Policy Research Institute

4:30-4:33pm	Session Introduction
4:33-4:48pm	<p><u>Nutrition as a Basic Need: A New Method for Utility-Consistent and Nutritionally Adequate Food Poverty Lines</u> (#7348)</p> <p>– Kristi Mahrt, International Food Policy Research Institute (IFPRI)</p>
4:48-4:58pm	Discussion
4:58-5:13pm	<p><u>Measuring Changes in Diet Deprivation: New Indicators and Methods</u> (#7298)</p> <p>– Karl Pauw, International Food Policy Research Institute (IFPRI)</p>
5:13-5:23pm	Discussion
5:23-5:38pm	<p><u>Agrifood Sector Growth, Poverty, and Diet Quality in Low-Income Countries</u> (#7296)</p> <p>– Luis Escalante, IFPRI</p>
5:38-5:48pm	Discussion
5:48-5:50pm	Session Closing

WEDNESDAY, JUNE 5

Presentation Schedule

Presenters should arrive to their assigned session room 10 minutes prior to the start of the session with their presentation on a USB drive in both PowerPoint and PDF formats. Times listed within each session are targets and may vary slightly.

**Looking for a paper?**

Search by ID# at: <http://www.gtap.org/events/conferences/2024/>

Time (MDT, UTC-6)	Event	Location
4:30-6:15pm	Organized Session #13	302 (Longs Peak)

Bridging Generations: The 1st Symposium for Aspiring Scholars and CGE Modeling Pioneers

Organized by: Anton Yang, Department of Economics, Yale University
 Jiansuo Pei, School of Applied Economics, Renmin University of China
Session Chair: Thomas Hertel, Center for Global Trade Analysis, Department of Agricultural Economics, Purdue University

4:30-4:33pm	Session Introduction
4:33-4:48pm	<u>From Pollution to Profit: Impacts of Black and Malodorous Water Remediation Program on Land Transactions in China</u> (#7243) – Ziyang Long, Renmin University of China
4:48-4:58pm	Discussion
4:58-5:13pm	<u>Robots Reshaping Spatial Dynamics: The Quantitative Effects of Robots on Chinese Firms' Global Relocation Trends</u> (#7288) – Chen Zheang, Renmin University of China
5:13-5:23pm	Discussion
5:23-5:38pm	<u>Responses of China's Cross-border Investors to Domestic Environmental Regulations</u> (#7166) – Kang Lin, Academy of Mathematics and Systems Science, Chinese Academy of Sciences
5:38-5:48pm	Discussion
5:48-6:03pm	<u>Measuring the Risk of Foreign Supply Chain Exposure</u> (#7247) – Yu Zhao, Academy of Mathematics and Systems Science, Chinese Academy of Sciences
6:03-6:13pm	Discussion
6:13-6:15pm	Session Closing

WEDNESDAY, JUNE 5

Presentation Schedule

Presenters should arrive to their assigned session room 10 minutes prior to the start of the session with their presentation on a USB drive in both PowerPoint and PDF formats. Times listed within each session are targets and may vary slightly.

**Looking for a paper?**

Search by ID# at: <http://www.gtap.org/events/conferences/2024/>

Time (MDT, UTC-6)	Event	Location
4:30-6:15pm	Session #14	304

Global Value Chains and Decoupling

Session Chair: Alessandro Antimiani, European Commission, DG TRADE

4:30-4:33pm Session Introduction

4:33-4:48pm **Does Participating in Global Value Chains Lead to Export Quality Upgrading?** (#7188)

– Lin Shi, American University

4:48-4:58pm Discussion

4:58-5:13pm **A new mechanism for trade agreement to revitalize the Global Value Chains** (#7305)

– Himanshu Jaiswal, IGIDR

5:13-5:23pm Discussion

5:23-5:38pm **EU-China Decoupling by the numbers: mapping the realignment of global value chains** (#7153)

– Luca Salvatici, Università Roma Tre

5:38-5:48pm Discussion

5:48-6:03pm **The Impact of Geoeconomic Decoupling: The Risks from Fragmented Global Economy** (#7193)

– Susumu Suzuki, Economic and Social Research Institute, Cabinet Office, Government of Japan

6:03-6:13pm Discussion

6:13-6:15pm Session Closing

WEDNESDAY, JUNE 5

Presentation Schedule

Presenters should arrive to their assigned session room 10 minutes prior to the start of the session with their presentation on a USB drive in both PowerPoint and PDF formats. Times listed within each session are targets and may vary slightly.

**Looking for a paper?**

Search by ID# at: <http://www.gtap.org/events/conferences/2024/>

Time (MDT, UTC-6)	Event	Location
4:30-5:50pm	Session #15	306

Climate Policy and Impacts

Session Chair: Jared Creason, US EPA

4:30-4:33pm Session Introduction

4:33-4:48pm **Climate changes and tourism: an estimate of the impact on the economy of Salvador, a Brazilian municipality** (#7160)

– **Gessica Souza**, National School of Public Administration - ENAP

4:48-4:58pm Discussion

4:58-5:13pm **Global Economic Impact of Wildfire Smoke** (#7251)

– **Lifeng Ren**, University of Minnesota-Applied Economics

5:13-5:23pm Discussion

5:23-5:38pm **Evaluating the Economic and Socioeconomic Impacts of Labor Heat Stress in Brazil: A Multiscale Approach** (#7183)

– **Thiago Simonato**, Center for Global Trade Analysis, Department of Agricultural Economics, Purdue University

5:38-5:48pm Discussion

5:48-5:50pm Session Closing

WEDNESDAY, JUNE 5

Presentation Schedule

Presenters should arrive to their assigned session room 10 minutes prior to the start of the session with their presentation on a USB drive in both PowerPoint and PDF formats. Times listed within each session are targets and may vary slightly.

**Looking for a paper?**

Search by ID# at: <http://www.gtap.org/events/conferences/2024/>

Time (MDT, UTC-6)	Event	Location
4:30-6:15pm	Session #16	308

Agricultural and Sustainability Policies

Session Chair: Kirsten Boysen-Urban, University of Hohenheim

4:30-4:33pm Session Introduction

4:33-4:48pm **Pesticide Regulatory Heterogeneity, Trade, and Global Agricultural Value Chains** (#7287)

– Bernhard Dalheimer, Purdue University

4:48-4:58pm Discussion

4:58-5:13pm **Effects of Trade Facilitation on Trade Performance in Africa: Implication for Agri-food Sector** (#7144)

– Moukaila Mouzamilou Takpara, United Nations Economic Commission for Africa

5:13-5:23pm Discussion

5:23-5:38pm **Reimagining Sustainable Intensification: A Novel Application of Modern Portfolio Theory within a General Equilibrium Framework** (#7309)

– Angga Pradesha, IFPRI

5:38-5:48pm Discussion

5:48-6:03pm **The EU Deforestation Regulation and Cocoa: What's the Impact?** (#7295)

– Ole Boysen, European Commission, Joint Research Centre (JRC)

6:03-6:13pm Discussion

6:13-6:15pm Session Closing

6:15-8:45pm	Reception	Ballroom B/C/D
-------------	-----------	----------------

ANNUAL CONFERENCE ON GLOBAL ECONOMIC ANALYSIS

THURSDAY, JUNE 6

Session Overview

Session details for this day are listed on pages 32-52. You can also access the conference schedule through the **Whova** mobile app (see page 3).

MDT (UTC-6)	Session	Location
9:00-10:45am	Session #17 - Pg. 32 <i>Global Climate Change Policies</i>	300
	Organized Session #18 - Pg. 33 <i>Economic Impacts and Policy Analysis in International Trade</i>	302 (Longs Peak)
	Organized Session #19 - Pg. 34 <i>Exploring the Effects of Trade & Climate Mitigation Policies in Domestic, International & Sectoral Dimensions</i>	304
	Session #20 - Pg. 35 <i>Livestock Modeling</i>	306
	Session #21 - Pg. 36 <i>Segmented Markets, Macro TFP Growth, Demographic Projections on Trade, Alternative Investment Schemes</i>	308
10:45-11:15am	Coffee Break	Ballroom B/C/D
11:15am-1:00pm	Organized Session #22 - Pg. 37 <i>From Regional Integration to GVC Participation: AfCFTA as a Catalyst for Strengthening Trade Ties</i>	300
	Organized Session #23 - Pg. 38 <i>Incorporating new sectoral details into GTAP: cases of livestock, fertilizers, critical mineral and plastic</i>	302 (Longs Peak)
	Session #24 - Pg. 39 <i>Agricultural Policies</i>	304
	Session #25 - Pg. 40 <i>Climate Change Policy, Land Use, and Renewable Energy</i>	306
	Session #26 - Pg. 41 <i>Student Levies, Cash Transfer Programs, Nutritional Assistance, and National Environmental Commitments</i>	308
1:00-2:15pm	Lunch	Ballroom B/C/D
2:15-4:00pm	Organized Session #27 - Pg. 42 <i>Global Trade Dynamics and Value Chain Analysis</i>	300
	Organized Session #28 - Pg. 43 <i>Modern industrial policies, climate change, and FDI</i>	302 (Longs Peak)
	Session #29 - Pg. 44 <i>Energy Modeling</i>	304
	Session #30 - Pg. 45 <i>Labor Market Assessments on Local Economies, the Agrifood Sector, and Gender Representation in CGE</i>	306
	Session #31 - Pg. 46 <i>Food Consumption, Inequality and Climate Change, and Global Dietary Shift on Environmental Sustainability</i>	308
4:00-4:30pm	Coffee Break	Ballroom B/C/D
4:30-6:15pm	Organized Session #32 - Pg. 47 <i>Advances in single country CGE modelling and relations to the GTAP Data Base – the case of MANAGE-WB</i>	300
	Organized Session #33 - Pg. 48 <i>Global Economic Analysis of Policies to Remain within the Planetary Boundaries</i>	302 (Longs Peak)
	Organized Session #34 - Pg. 49 <i>International Transport Costs, Non-Tariff Measures and US-China Phase 1 Agreement</i>	304
	Session #35 - Pg. 50 <i>Trade, Climate, and Environmental Policy</i>	306
	Session #36 - Pg. 51 <i>Sustainable Development: Agriculture, Inequality and Climate Change</i>	308
6:15-9:15pm	Dinner and Awards Ceremony	Ballroom B/C/D

THURSDAY, JUNE 6

Presentation Schedule

Presenters should arrive to their assigned session room 10 minutes prior to the start of the session with their presentation on a USB drive in both PowerPoint and PDF formats. Times listed within each session are targets and may vary slightly.

**Looking for a paper?**

Search by ID# at: <http://www.gtap.org/events/conferences/2024/>

Time (MDT, UTC-6)	Event	Location
8:00am-5:00pm	Onsite Check-in	3 rd Floor Lobby
9:00-10:45am	Session #17	300

Global Climate Change Policies

Session Chair: Aikaterini Kavallari, Food and Agriculture Organization of the United Nations

9:00-9:03am	Session Introduction
9:03-9:18am	<u>Analyzing the economic impacts of low-energy demand pathways based on CGE analysis</u> (#7232) – Jongwoo Moon, Korea Environment Institute
9:18-9:28am	Discussion
9:28-9:43am	<u>A WTO-Compatible Climate Club that Solves the Free-Rider Problem in Global Climate Policy</u> (#7143) – David G. Tarr, International School of Economics at TSU
9:43-9:53am	Discussion
9:53-10:08am	<u>Supply chain implications of energy investments to reach a 1.5 °C target</u> (#7289) – Rafael Garaffa, European Commission - JRC Seville
10:08-10:18am	Discussion
10:18-10:33am	<u>Land-Use Competition in a 1.5°C Climate Stabilization Pathway</u> (#7236) – Angelo Gurgel, Massachusetts Institute of Technology
10:33-10:43am	Discussion
10:43-10:45am	Session Closing

THURSDAY, JUNE 6

Presentation Schedule

Presenters should arrive to their assigned session room 10 minutes prior to the start of the session with their presentation on a USB drive in both PowerPoint and PDF formats. Times listed within each session are targets and may vary slightly.

**Looking for a paper?**

Search by ID# at: <http://www.gtap.org/events/conferences/2024/>

Time (MDT, UTC-6)	Event	Location
9:00-10:45am	Organized Session #18	302 (Longs Peak)

Economic Impacts and Policy Analysis in International Trade

Organized by: Anton Yang, Department of Economics, Yale University
 Wu Sanmang, China University of Geosciences, Beijing
Session Chair: Shantong Li, Development Research Center of the State Council

9:00-9:03am	Session Introduction
9:03-9:18am	<u>Quantitative Trade Models without "Proportionality": A Novel Approach to Trace Import Uses</u> (#7225) – Jiansuo Pei, School of Applied Economics, Renmin University of China
9:18-9:28am	Discussion
9:28-9:43am	<u>Resilience of the Global Electric Vehicle Market under Cobalt Supply Risk Shocks</u> (#7261) – Yuanchen Sun, China University of Geosciences, Beijing
9:43-9:53am	Discussion
9:53-10:08am	<u>Where Did the Processing Export Relocate to? An Optimization-Method-based Identification</u> (#7222) – Xiang Gao, Academy of Mathematics and Systems Science, Chinese Academy of Sciences
10:08-10:18am	Discussion
10:18-10:43am	Discussant – Ji Gao, China Energy Modeling Forum -- Environmental Defense Fund
10:43-10:45am	Session Closing

THURSDAY, JUNE 6

Presentation Schedule

Presenters should arrive to their assigned session room 10 minutes prior to the start of the session with their presentation on a USB drive in both PowerPoint and PDF formats. Times listed within each session are targets and may vary slightly.

**Looking for a paper?**

Search by ID# at: <http://www.gtap.org/events/conferences/2024/>

Time (MDT, UTC-6)	Event	Location
9:00-10:45am	Organized Session #19	304

Exploring the Effects of Trade and Climate Mitigation Policies in Domestic, International and Sectoral Dimensions

Organized by: Wen Jin Yuan, U.S. International Trade Commission
 Erwin Corong, Center for Global Trade Analysis, Department of Agricultural Economics, Purdue University
Session Chair: Wen Jin Yuan, U.S. International Trade Commission

9:00-9:03am	Session Introduction
9:03-9:18am	<u>Climate Mitigation Policies, Comparative Advantage in Trade and Restructuring of the Global Value Chains (GVCs) (#7346)</u> – Maryla Maliszewska, The World Bank
9:18-9:28am	Discussion
9:28-9:43am	<u>Dynamic Effects of the Inflation Reduction Act: a CGE Analysis (#7182)</u> – David Suarez-Cuesta, Universidad Complutense de Madrid
9:43-9:53am	Discussion
9:53-10:08am	<u>Incorporating Melitz into WiNDC (#7347)</u> – Alan Fox, US International Trade Commission (USITC)
10:08-10:18am	Discussion
10:18-10:33am	<u>The impact of Changes in Trade Policies on the Electric Vehicle (EV) Sector – a CGE Analysis (#7316)</u> – Wen Jin Yuan, U.S. International Trade Commission
10:33-10:43am	Discussion
10:43-10:45am	Session Closing

THURSDAY, JUNE 6**Presentation Schedule**

Presenters should arrive to their assigned session room 10 minutes prior to the start of the session with their presentation on a USB drive in both PowerPoint and PDF formats. Times listed within each session are targets and may vary slightly.

**Looking for a paper?**

Search by ID# at: <http://www.gtap.org/events/conferences/2024/>

Time (MDT, UTC-6)	Event	Location
9:00-10:45am	Session #20	306

Livestock Modeling

Session Chair: Amanda M. Countryman, Colorado State University

9:00-9:03am Session Introduction

9:03-9:18am **Analysis of trade policies with CAT linked livestock-crop model in the context of the ERS USDA International Baseline** (#7219)
 – Alla Golub, Center for Global Trade Analysis, Department of Agricultural Economics, Purdue University

9:18-9:28am Discussion

9:28-9:43am **Economic Impacts of Peste des Petits Ruminants (PPR) in Ethiopia** (#7239)
 – Golam Saroare Shakil, Washington State University

9:43-9:53am Discussion

9:53-10:08am **Potential Economic Impacts of African Swine Fever in Brazil** (#7250)
 – Tais Menezes, Colorado State University

10:08-10:18am Discussion

10:18-10:33am **Consumers preferences for beef based on color** (#7278)
 – Annika Thies, Thuenen Institut

10:33-10:43am Discussion

10:43-10:45am Session Closing

THURSDAY, JUNE 6

Presentation Schedule

Presenters should arrive to their assigned session room 10 minutes prior to the start of the session with their presentation on a USB drive in both PowerPoint and PDF formats. Times listed within each session are targets and may vary slightly.

**Looking for a paper?**

Search by ID# at: <http://www.gtap.org/events/conferences/2024/>

Time (MDT, UTC-6)	Event	Location
9:00-10:45am	Session #21	308
<i>Segmented Capital Markets, Macro TFP Growth, Demographic Projections on International Trade, and Alternative Investment Dynamics Schemes</i>		
Session Chair:	Marta Paczos, Department for Business & Trade	
9:00-9:03am	Session Introduction	
9:03-9:18am	<u>An investment determination mechanism with segmented capital markets</u> (#7221) – Hao (David) Cui, Wageningen Economic Research	
9:18-9:28am	Discussion	
9:28-9:43am	<u>On How to Achieve China's Necessary Macro TFP Growth</u> (#7190) – Zike Qi, Peking University	
9:43-9:53am	Discussion	
9:53-10:08am	<u>A new approach to demographic projections and its application to international trade</u> (#7223) – Kisshor Samyrao, Department for Business & Trade	
10:08-10:18am	Discussion	
10:18-10:33am	<u>Alternative Investment Dynamics Schemes: Implementation Based on A Recursive Dynamic Model</u> (#7294) – Mei Yuan, MIT Joint Program	
10:33-10:43am	Discussion	
10:43-10:45am	Session Closing	
10:45-11:15am	Coffee Break	Ballroom B/C/D

THURSDAY, JUNE 6

Presentation Schedule

Presenters should arrive to their assigned session room 10 minutes prior to the start of the session with their presentation on a USB drive in both PowerPoint and PDF formats. Times listed within each session are targets and may vary slightly.

**Looking for a paper?**

Search by ID# at: <http://www.gtap.org/events/conferences/2024/>

Time (MDT, UTC-6)	Event	Location
11:15am-12:35pm	Organized Session #22	300

From Regional Integration to GVC Participation: The AfCFTA as a Catalyst for Strengthening Regional and Global Trade Ties

Organized by: Lars Nilsson, European Commission – DG Trade
Caitlyn Carrico, United Nations Economic Commission for Africa

Session Chair: Lars Nilsson, European Commission – DG Trade

11:15-11:18am	Session Introduction
11:18-11:33am	<u>Trade integration beyond the AfCFTA: options and outcomes</u> (#7199) – Alessandro Antimiani, European Commission, DG TRADE
11:33-11:43am	Discussion
11:43-11:58am	<u>Implementing the AfCFTA Agreement and implications for Africa’s regional value chains</u> (#7312) – Maria Cristina Mitaritonna, CEPII
11:58am-12:08pm	Discussion
12:08-12:23pm	<u>The external agri-food commodities trade under the AfCFTA</u> (#7293) – Antti Simola, European Commission - Joint Research Center
12:23-12:33pm	Discussion
12:33-12:35pm	Session Closing

THURSDAY, JUNE 6

Presentation Schedule

Presenters should arrive to their assigned session room 10 minutes prior to the start of the session with their presentation on a USB drive in both PowerPoint and PDF formats. Times listed within each session are targets and may vary slightly.

**Looking for a paper?**

Search by ID# at: <http://www.gtap.org/events/conferences/2024/>

Time (MDT, UTC-6)	Event	Location
11:15am-1:00pm	Organized Session #23	302 (Longs Peak)

Incorporating new sectoral details into GTAP data and modeling framework: cases of livestock, fertilizers, critical mineral and plastic

Organized by: Maksym Chepeliev, Center for Global Trade Analysis, Department of Agricultural Economics, Purdue University
Session Chair: Dominique van der Mensbrugge, Center for Global Trade Analysis, Department of Agricultural Economics, Purdue University

11:15-11:18am	Session Introduction
11:18-11:33am	<u>Disaggregating Livestock Sector in the GTAP Data Base</u> (#7213) – Carlos Gonzalez Fischer, Cornell University
11:33-11:43am	Discussion
11:43-11:58am	<u>Fertilizers in the EU Carbon Border Adjustment Mechanism: Implications for Trade and the Environment</u> (#7172) – Elizabeth Fraysse, Center for Global Trade Analysis, Department of Agricultural Economics, Purdue University
11:58am-12:08pm	Discussion
12:08-12:23pm	<u>Incorporating Critical Minerals into the GTAP Circular Economy Data Base</u> (#7264) – Maksym Chepeliev, Center for Global Trade Analysis, Department of Agricultural Economics, Purdue University
12:23-12:33pm	Discussion
12:33-12:48pm	<u>Modelling plastic pollution in Southeast Asia</u> (#7303) – Ruben Bibas, OECD
12:48-12:58pm	Discussion
12:58-1:00pm	Session Closing

THURSDAY, JUNE 6

Presentation Schedule

Presenters should arrive to their assigned session room 10 minutes prior to the start of the session with their presentation on a USB drive in both PowerPoint and PDF formats. Times listed within each session are targets and may vary slightly.

**Looking for a paper?**

Search by ID# at: <http://www.gtap.org/events/conferences/2024/>

Time (MDT, UTC-6)	Event	Location
11:15am-1:00pm	Session #24	304

Agricultural Policies

Session Chair: Houssein Guimbard, CEPII

11:15-11:18am	Session Introduction
11:18-11:33am	<u>Optimizing Nutrient Management: A Cross-Border Analysis of Manure Trade Policies in NorthWestern-European Agriculture</u> (#7258) – Mariam Amadou Diallo, Ghent University
11:33-11:43am	Discussion
11:43-11:58am	<u>Impact of the Farm to Fork strategy and the EU's Common Agricultural Policy on the ability of the food system to cushion against multiple shocks</u> (#7299) – Kirsten Boysen-Urban, University of Hohenheim
11:58am-12:08pm	Discussion
12:08-12:23pm	<u>The effects of improved data, policy and accountability mechanisms on nutrition in Africa's middle and low-income countries</u> (#7163) – Greenwell Matchaya, IWMI
12:23-12:33pm	Discussion
12:33-12:48pm	<u>U.S. Agricultural Conservation Policy Effects on Global Agricultural Markets: Evidence from The Conservation Reserve Program</u> (#7254) – Ming Wang, Colorado State University, Department of Agricultural and Resource Economics <i>*GTAP Conference Scholars Program Participant</i>
12:48-12:58pm	Discussion
12:58-1:00pm	Session Closing

THURSDAY, JUNE 6

Presentation Schedule

Presenters should arrive to their assigned session room 10 minutes prior to the start of the session with their presentation on a USB drive in both PowerPoint and PDF formats. Times listed within each session are targets and may vary slightly.

**Looking for a paper?**

Search by ID# at: <http://www.gtap.org/events/conferences/2024/>

Time (MDT, UTC-6)	Event	Location
11:15am-1:00pm	Session #25	306

Climate Change Policy, Land Use, and Renewable Energy

Session Chair: Hugo Valin, OECD

11:15-11:18am	Session Introduction
11:18-11:33am	<u>Economy-wide impacts of output-based permit allocations in emissions trading schemes</u> (#7168) – Niven Winchester, Auckland University of Technology
11:33-11:43am	Discussion
11:43-11:58am	<u>New Induced Land Use Change (ILUC) emissions assessment: Updates from IPCC guidelines and new estimates of soil carbon from the Harmonized World Soil Database (HWSD)</u> (#7230) – Lauren Benavidez, Center for Global Trade Analysis, Department of Agricultural Economics, Purdue University
11:58am-12:08pm	Discussion
12:08-12:23pm	<u>Could Digital Economy help China's Provincial Carbon Emission Reduction?</u> (#7248) – Lingling Zhou, China University of Geosciences Beijing
12:23-12:33pm	Discussion
12:33-12:48pm	<u>Cross-border effects of climate policy packages in North America</u> (#7321) – Sneha Thube, International Monetary Fund
12:48-12:58pm	Discussion
12:58-1:00pm	Session Closing

THURSDAY, JUNE 6

Presentation Schedule

Presenters should arrive to their assigned session room 10 minutes prior to the start of the session with their presentation on a USB drive in both PowerPoint and PDF formats. Times listed within each session are targets and may vary slightly.

**Looking for a paper?**

Search by ID# at: <http://www.gtap.org/events/conferences/2024/>

Time (MDT, UTC-6)	Event	Location
11:15am-1:00pm	Session #26	308

Domestically-driven Policies on Student Levies, Cash Transfer Programs, Supplemental Nutrition Assistance, and National Environmental Commitments

Session Chair: Justin Johnson, University of Minnesota

11:15-11:18am	Session Introduction
11:18-11:33am	<u>The economic effects of an international student levy under alternative price elasticity assumptions</u> (#7141) – Xianglong Locky Liu, Centre of Policy Studies, Victoria University
11:33-11:43am	Discussion
11:43-11:58am	<u>Conditional cash transfer programs and poverty in Morocco: An ex-ante assessment of the direct social assistance program and its socioeconomic impacts using a recursive dynamic computable general equilibrium model</u> (#7226) – Nabil El Baouchari, Mohammed V University in Rabat
11:58am-12:08pm	Discussion
12:08-12:23pm	<u>Economywide Impacts of the Supplemental Nutrition Assistance Program</u> (#7216) – Jessica Osanya, Oregon State University *GTAP Conference Scholars Program Participant
12:23-12:33pm	Discussion
12:33-12:48pm	<u>The global impact of national environmental commitments</u> (#7333) – Alex Watkins, University of Queensland *GTAP Conference Scholars Program Participant
12:48-12:58pm	Discussion
12:58-1:00pm	Session Closing

THURSDAY, JUNE 6

Presentation Schedule

Presenters should arrive to their assigned session room 10 minutes prior to the start of the session with their presentation on a USB drive in both PowerPoint and PDF formats. Times listed within each session are targets and may vary slightly.

**Looking for a paper?**

Search by ID# at: <http://www.gtap.org/events/conferences/2024/>

Time (MDT, UTC-6)	Event	Location
1:00-2:15pm	Lunch	Ballroom B/C/D
2:15-4:00pm	Organized Session #27	300

Global Trade Dynamics and Value Chain Analysis

Organized by: Anton Yang, Department of Economics, Yale University
 Shantong Li, Development Research Center of the State Council
Session Chair: Cuihong Yang, Academy of Mathematics and Systems Science, CAS

2:15-2:18pm	Session Introduction
2:18-2:33pm	<u>Digital Service Trade and Global Value Chain Division</u> (#7238) – Yan Xia, Institutes of Science and Development, CAS
2:33-2:43pm	Discussion
2:43-2:58pm	<u>An Analysis of the Regional Economic Impacts of FDI Fluctuations in China</u> (#7272) – Jiaze Sun, Tsinghua University
2:58-3:08pm	Discussion
3:08-3:23pm	<u>Chinese Provincial CO2 Emission Flows in Global Production</u> (#7152) – Chen Pan, Chinese Academy of Social Sciences
3:23-3:33pm	Discussion
3:33-3:58pm	Discussant – Xiang Gao, Academy of Mathematics and Systems Science, Chinese Academy of Sciences
3:58-4:00pm	Session Closing

THURSDAY, JUNE 6

Presentation Schedule

Presenters should arrive to their assigned session room 10 minutes prior to the start of the session with their presentation on a USB drive in both PowerPoint and PDF formats. Times listed within each session are targets and may vary slightly.

**Looking for a paper?**

Search by ID# at: <http://www.gtap.org/events/conferences/2024/>

Time (MDT, UTC-6)	Event	Location
2:15-3:10pm	Organized Session #28	302 (Longs Peak)

Modern industrial policies, climate change, and FDI

Organized by: Eddy Bekkers, World Trade Organization
Session Chair: Erwin Corong, Center for Global Trade Analysis, Department of Agricultural Economics, Purdue University

2:15-2:18pm	Session Introduction
2:18-2:33pm	<u>Facelifting and Extending the GTAP-FDI Model based on New Datasets of FDI and FAS with an Application on the Investment Facilitation for Development</u> (#7336) — Yu Roger So, Graduate Institute of International and Development Studies
2:33-2:43pm	Discussion
2:43-2:58pm	<u>Trade and competitiveness effects of different decarbonisation policies</u> (#7311) — Eddy Bekkers, World Trade Organization
2:58-3:08pm	Discussion
3:08-3:10pm	Session Closing

THURSDAY, JUNE 6

Presentation Schedule

Presenters should arrive to their assigned session room 10 minutes prior to the start of the session with their presentation on a USB drive in both PowerPoint and PDF formats. Times listed within each session are targets and may vary slightly.

**Looking for a paper?**

Search by ID# at: <http://www.gtap.org/events/conferences/2024/>

Time (MDT, UTC-6)	Event	Location
2:15-4:00pm	Session #29	304

Energy Modeling

Session Chair: Farzad Taheripour, Department of Agricultural Economics, Purdue University

2:15-2:18pm Session Introduction

2:18-2:33pm **Economic and Environmental Impacts of Phasing Out Coal Power Generation in East Asia** (#7265)

– Xiujian Peng, Centre of Policy Studies, Victoria University

2:33-2:43pm Discussion

2:43-2:58pm **Using GTAP-POWER for Analysing Investment Heterogeneity: China's Energy Investment Impacts in the Belt and Road Countries** (#7156)

– Ge Yin, University College London

2:58-3:08pm Discussion

3:08-3:23pm **Economywide Consequences of Widespread, Long Duration Electric Power Interruptions: Evidence from the Greater Chicago Area** (#7320)

– Adam Rose, University of Southern California

3:23-3:33pm Discussion

3:33-3:48pm **The Energy Security Gains from Strengthening Europe's Climate Action** (#7162)

– Hugo Rojas-Romagosa, International Monetary Fund

3:48-3:58pm Discussion

3:58-4:00pm Session Closing

THURSDAY, JUNE 6

Presentation Schedule

Presenters should arrive to their assigned session room 10 minutes prior to the start of the session with their presentation on a USB drive in both PowerPoint and PDF formats. Times listed within each session are targets and may vary slightly.

**Looking for a paper?**

Search by ID# at: <http://www.gtap.org/events/conferences/2024/>

Time (MDT, UTC-6)	Event	Location
2:15-3:35pm	Session #30	306

Labor Market Assessments on Local Economies, the Agrifood Sector, and Gender Representation in CGE Modeling

Session Chair: Hans Lofgren, Independent Researcher

2:15-2:18pm **Session Introduction**

2:18-2:33pm **Assessing the impacts of workforce skill improvement on income transfer programme beneficiaries in Brazil** (#7184)
 – **Rayan Wolf**, Universidade Estadual de Mato Grosso do Sul
**Ken Pearson Travel Funding Award Recipient*

2:33-2:43pm **Discussion**

2:43-2:58pm **Employment and Job Quality in Agrifood Production** (#7325)
 – **Will Martin**, International Food Policy Research Institute (IFPRI)

2:58-3:08pm **Discussion**

3:08-3:23pm **Approaches to Gendered CGE Modeling: Review of the Literature and Applied Comparative Analysis** (#7180)
 – **Martin Cicowiez**, CEDLAS-Universidad Nacional de La Plata

3:23-3:33pm **Discussion**

3:33-3:35pm **Session Closing**

THURSDAY, JUNE 6

Presentation Schedule

Presenters should arrive to their assigned session room 10 minutes prior to the start of the session with their presentation on a USB drive in both PowerPoint and PDF formats. Times listed within each session are targets and may vary slightly.

**Looking for a paper?**

Search by ID# at: <http://www.gtap.org/events/conferences/2024/>

Time (MDT, UTC-6)	Event	Location
2:15-3:35pm	Session #31	308
<i>Food Consumption, Inequality and Climate Change, and Global Dietary Shift on Environmental Sustainability</i>		
Session Chair:	Srabashi Ray, Center for Global Trade Analysis, Department of Agricultural Economics, Purdue University	
2:15-2:18pm	Session Introduction	
2:18-2:33pm	<u>Productivity Gains in the Cerrado: Impact on Food Consumption in Brazil</u> (#7253) – Elisagela Gelatti, University Sao Paulo	
2:33-2:43pm	Discussion	
2:43-2:58pm	<u>Food inequality and climate change: compounding impacts on caloric undernutrition</u> (#7345) – Uris Lantz Baldos, Center for Global Trade Analysis, Department of Agricultural Economics, Purdue University	
2:58-3:08pm	Discussion	
3:08-3:23pm	<u>The implications of a global dietary shift on Australia's economic and environmental sustainability: a model-based general equilibrium analysis</u> (#7187) – Yingying Lu, CSIRO	
3:23-3:33pm	Discussion	
3:33-3:35pm	Session Closing	
4:00-4:30pm	Coffee Break	Ballroom B/C/D

THURSDAY, JUNE 6

Presentation Schedule

Presenters should arrive to their assigned session room 10 minutes prior to the start of the session with their presentation on a USB drive in both PowerPoint and PDF formats. Times listed within each session are targets and may vary slightly.

**Looking for a paper?**

Search by ID# at: <http://www.gtap.org/events/conferences/2024/>

Time (MDT, UTC-6)	Event	Location
4:30-5:50pm	Organized Session #32	300

Advances in single country CGE modelling and relations to the GTAP Data Base – the case of MANAGE-WB

Organized by: Martin Aaroe Christensen, World Bank

Session Chair: Martin Aaroe Christensen, World Bank

4:30-4:33pm	Session Introduction
4:33-4:48pm	<u>Getting the best of two worlds? Combing single country data and the GTAP Data Base for work with MANAGE-WB</u> (#7229) – Lulit Mitik Beyene, World Bank
4:48-4:58pm	Discussion
4:58-5:13pm	<u>Modularity and flexibility in MANAGE-WB: model structure and the methodological approach</u> (#7231) – Ragchaasuren Galindev, World Bank
5:13-5:23pm	Discussion
5:23-5:38pm	<u>Using the MANAGE-WB model in World Bank analytical and advisory work</u> (#7266) – Martin Aaroe Christensen, World Bank
5:38-5:48pm	Discussion
5:48-5:50pm	Session Closing

THURSDAY, JUNE 6

Presentation Schedule

Presenters should arrive to their assigned session room 10 minutes prior to the start of the session with their presentation on a USB drive in both PowerPoint and PDF formats. Times listed within each session are targets and may vary slightly.

**Looking for a paper?**

Search by ID# at: <http://www.gtap.org/events/conferences/2024/>

Time (MDT, UTC-6)	Event	Location
4:30-6:15pm	Organized Session #33	302 (Longs Peak)

Global Economic Analysis of Policies to Remain within the Planetary Boundaries

Organized by: Thomas Hertel, Center for Global Trade Analysis, Department of Agricultural Economics, Purdue University
Session Chair: Channing Arndt, International Food Policy Research Institute / CGIAR

4:30-4:33pm	Session Introduction
4:33-4:48pm	<u>An Economic Perspective on Planetary Boundaries</u> (#7214) – Edward Barbier, Colorado State University
4:48-4:58pm	Discussion
4:58-5:13pm	<u>Global and Local Policies for Respecting Planetary Boundaries: Tradeoffs and Synergies</u> (#7227) – Thomas Hertel, Center for Global Trade Analysis, Department of Agricultural Economics, Purdue University
5:13-5:23pm	Discussion
5:23-5:38pm	<u>What is possible versus how to get there: Integrating economic models with biophysical efficiency frontiers</u> (#7342) – Justin Johnson, University of Minnesota
5:38-5:48pm	Discussion
5:48-6:03pm	<u>Space Pirates, or, Subsidizing Industrial Sabotage in Outer Space</u> (#7139) – Joseph Francois, University of Bern, World Trade Institute
6:03-6:13pm	Discussion
6:13-6:15pm	Session Closing

THURSDAY, JUNE 6

Presentation Schedule

Presenters should arrive to their assigned session room 10 minutes prior to the start of the session with their presentation on a USB drive in both PowerPoint and PDF formats. Times listed within each session are targets and may vary slightly.

**Looking for a paper?**

Search by ID# at: <http://www.gtap.org/events/conferences/2024/>

Time (MDT, UTC-6)	Event	Location
4:30-5:25pm	Organized Session #34	304

International Transport Costs, Non-Tariff Measures and US-China Phase 1 Agreement

Organized by: Erwin Corong, Center for Global Trade Analysis, Department of Agricultural Economics, Purdue University

Ralf Peters, United Nations Conference on Trade and Development

Session Chair: Erwin Corong, Center for Global Trade Analysis, Department of Agricultural Economics, Purdue University

4:30-4:33pm Session Introduction

4:33-4:48pm **Economic and Trade Implications of maritime fuel levy: An Assessment using the GTAP modeling framework** (#7354)

– Ralf Peters, United Nations Conference on Trade and Development

4:48-4:58pm Discussion

4:58-5:13pm **Impact of Non-Tariff Measures on ASEAN Trade: A Panel Data Approach** (#7302)

– Pattawee Puangchit, Center for Global Trade Analysis, Department of Agricultural Economics, Purdue University

5:13-5:23pm Discussion

5:23-5:25pm Session Closing

THURSDAY, JUNE 6

Presentation Schedule

Presenters should arrive to their assigned session room 10 minutes prior to the start of the session with their presentation on a USB drive in both PowerPoint and PDF formats. Times listed within each session are targets and may vary slightly.

**Looking for a paper?**

Search by ID# at: <http://www.gtap.org/events/conferences/2024/>

Time (MDT, UTC-6)	Event	Location
4:30-6:15pm	Session #35	306

Trade, Climate, and Environmental Policy

Session Chair: Xin Zhao, Joint Global Change Research Institute, PNNL

4:30-4:33pm	Session Introduction
4:33-4:48pm	<u>Trade Policy as Climate Policy: Payoffs and Tradeoffs</u> (#7164) – Karen Thierfelder, USNA-ECONOMICS DEPT
4:48-4:58pm	Discussion
4:58-5:13pm	<u>Climate change adaptation: Agricultural productivity shocks and trade policy responses</u> (#7224) – Hendrik Mahlkow, Kiel Institute for the World Economy
5:13-5:23pm	Discussion
5:23-5:38pm	<u>Declining demand for Australia’s fossil fuel exports, potential economic impacts, and policy responses</u> (#7150) – Cedric Hodges, Deloitte Access Economics
5:38-5:48pm	Discussion
5:48-6:03pm	<u>Welfare consequences of government budget closure assumptions under new environmental policies</u> (#7186) – Jonathon Becker, US EPA
6:03-6:13pm	Discussion
6:13-6:15pm	Session Closing

THURSDAY, JUNE 6

Presentation Schedule

Presenters should arrive to their assigned session room 10 minutes prior to the start of the session with their presentation on a USB drive in both PowerPoint and PDF formats. Times listed within each session are targets and may vary slightly.

**Looking for a paper?**

Search by ID# at: <http://www.gtap.org/events/conferences/2024/>

Time (MDT, UTC-6)	Event	Location
4:30-5:50pm	Session #36	308

Sustainable Development: Agriculture, Inequality and Climate Change

Session Chair: Ole Boysen, European Commission, Joint Research Centre (JRC)

4:30-4:33pm Session Introduction

4:33-4:48pm **Redirecting Agricultural Subsidies to Achieve Global Sustainability Goals** (#7350)
– Elsa Olivetti, FAO

4:48-4:58pm Discussion

4:58-5:13pm **Future Employment in Global Agriculture: Trends and Drivers in the Shared Socioeconomic Pathways** (#7198)
– Debbora Leip, Potsdam Institute for Climate Impact Research
**Alex Meeraus / Thomas Rutherford Travel Funding Award Recipient*

5:13-5:23pm Discussion

5:23-5:38pm **Within-country inequality and climate change - A model for IAMs with an application to multiple countries** (#7200)
– Yu Zheng, CEPII

5:38-5:48pm Discussion

5:48-5:50pm Session Closing

THURSDAY, JUNE 6

Presentation Schedule

Presenters should arrive to their assigned session room 10 minutes prior to the start of the session with their presentation on a USB drive in both PowerPoint and PDF formats. Times listed within each session are targets and may vary slightly.



Looking for a paper?

Search by ID# at: <http://www.gtap.org/events/conferences/2024/>

Time (MDT, UTC-6)	Event	Location
6:15-9:15pm	Dinner and Awards Ceremony	Ballroom B/C/D



Awards Ceremony (approx. 7:00pm)

- Conference Co-Organizers
- Alan A. Powell Award
- GTAP Hall of Fame
- GTAP Research Fellows
- Early Career Researcher Travel Funding Awards
- GTAP Conference Scholars Program

FRIDAY, JUNE 7

Distinguished Plenary Speaker

Optimal Unilateral Carbon Policy



Samuel Kortum

Director of the Cowles Foundation, James Burrows Moffatt Professor of Economics and Professor of Management
Yale University

<https://economics.yale.edu/people/samuel-kortum>

Samuel Kortum is the James Burrows Moffatt Professor of Economics at Yale University. He also serves as Director of the Cowles Foundation for Economic Research and on the Board of the National Bureau of Economic Research. He currently works on issues in international economics, but his early research explored technological change, inspired by Robert Evenson, Ariel Pakes, and Zvi Griliches (Evenson and Pakes were his dissertation advisors at Yale and Griliches was theirs). Kortum's contribution from this period appeared as "Research, Patenting, and Technological Change" in *Econometrica*. It showed how a process of random search for better techniques of production could serve as an analytical foundation for understanding economic growth. As an assistant professor at Boston University, Kortum began working with Jonathan Eaton, who pushed him to consider the international dimensions of technological change. They soon collaborated to build quantitative models of international technology diffusion, in which ideas from the research of one country contribute to the growth of another. Almost by chance they thought to incorporate goods trade into that framework, discovering that it provided a transparent method of extending Ricardian trade theory to a world of many goods and countries separated by trade frictions. Their paper "Technology, Geography, and Trade," was published in *Econometrica* in 2002 and earned them the Frisch Medal in 2004. Eaton and Kortum have collaborated ever since, receiving the Onassis Prize in International Trade in 2018. Before coming to Yale, Kortum was a professor at Boston University, the University of Minnesota, and the University of Chicago, where he served as an editor of the *Journal of Political Economy* from 2008-2012. He is a Fellow of the Econometric Society and Member of the American Academy of Arts and Sciences. Kortum received his bachelor's degree from Wesleyan University in 1983 and Ph.D. in Economics from Yale in 1992.

ANNUAL CONFERENCE ON GLOBAL ECONOMIC ANALYSIS

FRIDAY, JUNE 7

Session Overview

Session details for this day are listed on pages 55-71. You can also access the conference schedule through the **Whova** mobile app (see page 3).

MDT (UTC-6)	Session	Location
9:00-10:45am	Organized Session #37 - Pg. 55 <i>Advances in modeling domestic and trade-related climate policies in the GTAP-E framework</i>	300
	Organized Session #38 - Pg. 56 <i>New insights and frontiers in modeling climate change</i>	302 (Longs Peak)
	Session #39 - Pg. 57 <i>Model Validation</i>	304
	Session #40 - Pg. 58 <i>US Agricultural and Trade Policies</i>	306
	Session #41 - Pg. 59 <i>Food Systems</i>	308
10:45-11:15am	Coffee Break	Ballroom B/C/D
11:15am-12:35pm	Organized Session #42 - Pg. 60 <i>Climate Mitigation and Income Distribution: New Insights from the National, Regional and Global Studies</i>	300
	Organized Session #43 - Pg. 61 <i>Advances in modeling the standard GTAP model in GAMS</i>	302 (Longs Peak)
	Organized Session #44 - Pg. 62 <i>Re-thinking the way we model commodity trade flows</i>	304
	Session #45 - Pg. 63 <i>Carbon Border Adjustment Mechanisms</i>	306
	Session #46 - Pg. 64 <i>Aluminum Use, Steelmaking in Climate Change Mitigation, and Fuel Usage in GE Modeling</i>	308
	Organized Session #47 - Pg. 65 <i>The animal food sector's future: new results on emission, demand, production, trade, and health outcomes</i>	312
	Lunch	Ballroom B/C/D
1:50-3:35pm	Organized Session #48 - Pg. 66 <i>The 4th Seminar on Bridging the Gap between CGE and NQTM: Spatial Competition, Spatial Risk, Anti-Granularity, and Clean Growth</i>	300
	Organized Session #49 - Pg. 67 <i>Developments and Extensions in GTAP Modeling</i>	302 (Longs Peak)
	Session #50 - Pg. 68 <i>Pandemic and Conflict Assessments</i>	304
	Session #51 - Pg. 69 <i>Supply Chains</i>	306
	Session #52 - Pg. 70 <i>Greenhouse Gas Emissions and Carbon Neutrality</i>	308
3:35-4:05pm	Coffee Break	Ballroom B/C/D
4:05-5:20pm	Plenary Session and Closing Remarks - Pg. 71 <i>Optimal Unilateral Carbon Policy</i>	Ballroom A

FRIDAY, JUNE 7

Presentation Schedule

Presenters should arrive to their assigned session room 10 minutes prior to the start of the session with their presentation on a USB drive in both PowerPoint and PDF formats. Times listed within each session are targets and may vary slightly.

**Looking for a paper?**

Search by ID# at: www.gtap.org/events/conferences/2024/

Time (MDT, UTC-6)	Event	Location
8:00am-1:00pm	Onsite Check-in	3 rd Floor Lobby
9:00-10:45am	Organized Session #37	300

Advances in modeling domestic and trade-related climate policies in the GTAP-E framework

Organized by: Francesco Clora, Department of Food and Resource Economics, Faculty of Science, University of Copenhagen
 Erwin Corong, Center for Global Trade Analysis, Department of Agricultural Economics, Purdue University
Session Chair: Francesco Clora, Department of Food and Resource Economics, Faculty of Science, University of Copenhagen

9:00-9:03am	Session Introduction
9:03-9:18am	<p><u>Assessing the economy-wide impacts of domestic and international climate policies using the GTAP Integrated Assessment Model (GTAP-IAM) (#7318)</u></p> <ul style="list-style-type: none"> – Erwin Corong, Center for Global Trade Analysis, Department of Agricultural Economics, Purdue University
9:18-9:28am	Discussion
9:28-9:43am	<p><u>The European Green Deal: understanding the relevance of domestic climate policy details, CBAM's embedded emissions and exporters' carbon price rebates (#7178)</u></p> <ul style="list-style-type: none"> – Francesco Clora, Department of Food and Resource Economics, Faculty of Science, University of Copenhagen
9:43-9:53am	Discussion
9:53-10:08am	<p><u>Carbon border adjustment, agricultural abatement technology adoptions in exporting countries, and technology spillovers (#7233)</u></p> <ul style="list-style-type: none"> – Laerke Jensbye, University of Copenhagen
10:08-10:18am	Discussion
10:18-10:20am	Session Closing

FRIDAY, JUNE 7

Presentation Schedule

Presenters should arrive to their assigned session room 10 minutes prior to the start of the session with their presentation on a USB drive in both PowerPoint and PDF formats. Times listed within each session are targets and may vary slightly.



Looking for a paper?

Search by ID# at: www.gtap.org/events/conferences/2024/

Time (MDT, UTC-6)	Event	Location
9:00-10:20am	Organized Session #38	302 (Longs Peak)

New insights and frontiers in modeling climate change

Organized by: Channing Arndt, International Food Policy Research Institute / CGIAR
Session Chair: Channing Arndt, International Food Policy Research Institute / CGIAR

9:00-9:03am	Session Introduction
9:03-9:18am	<u>Estimating the Impact of Climate Change on Agricultural TFP</u> (#7220) – Timothy Thomas, International Food Policy Research Institute (IFPRI)
9:18-9:28am	Discussion
9:28-9:43am	<u>Revisiting Development Strategy Under Climate Uncertainty: Case Study of Malawi</u> (#7155) – Askar Mukashov, IFPRI
9:43-9:53am	Discussion
9:53-10:08am	<u>Climate change and central banking in Africa</u> (#7286) – Channing Arndt, International Food Policy Research Institute / CGIAR
10:08-10:18am	Discussion
10:18-10:20am	Session Closing

FRIDAY, JUNE 7

Presentation Schedule

Presenters should arrive to their assigned session room 10 minutes prior to the start of the session with their presentation on a USB drive in both PowerPoint and PDF formats. Times listed within each session are targets and may vary slightly.

**Looking for a paper?**

Search by ID# at: www.gtap.org/events/conferences/2024/

Time (MDT, UTC-6)	Event	Location
9:00-10:45am	Session #39	304

Model Validation

Session Chair: Marcel Adenauer, OECD

9:00-9:03am Session Introduction

9:03-9:18am **Structural change in the Australian economy, 2011 to 2023: An Historical CGE Analysis** (#7340)
 – Janine Dixon, Centre of Policy Studies, Victoria University

9:18-9:28am Discussion

9:28-9:43am **Estimating technology and preference trends, validating and creating baseline projections with the GTAP model** (#7255)
 – Maureen Rimmer, Centre of Policy Studies

9:43-9:53am Discussion

9:53-10:08am **An Ex-Ante Evaluation of Deeper Integration among South Asia and Southeast Asia: A General Equilibrium Analysis** (#7353)
 – Mustajab Khatir, Birla Institute of Technology and Sciences - Hyderabad Campus
**GTAP Conference Scholars Program Participant*

10:08-10:18am Discussion

10:18-10:33am **Ex-Post Model Validation Assessment in the Wake of the Ukraine Conflict: Learning Lessons and Reflections** (#7343)
 – Marcel Adenauer, OECD

10:33-10:43am Discussion

10:43-10:45am Session Closing

FRIDAY, JUNE 7

Presentation Schedule

Presenters should arrive to their assigned session room 10 minutes prior to the start of the session with their presentation on a USB drive in both PowerPoint and PDF formats. Times listed within each session are targets and may vary slightly.

**Looking for a paper?**

Search by ID# at: www.gtap.org/events/conferences/2024/

Time (MDT, UTC-6)	Event	Location
9:00-10:45am	Session #40	306

US Agricultural and Trade Policies

Session Chair: Amanda M. Countryman, Colorado State University

9:00-9:03am Session Introduction

9:03-9:18am

US Trade Policy Stagnation: the effects on US Agriculture (#7327)

- Angel Aguiar, Center for Global Trade Analysis, Department of Agricultural Economics, Purdue University

9:18-9:28am

Discussion

9:28-9:43am

U.S. Employment Exposure to Agricultural Trade Policy (#7237)

- Diane Charlton, Montana State University

9:43-9:53am

Discussion

9:53-10:08am

Reversing Deep Integration: The Case of US-Mexico Corn Trade (#7310)

- Dewey Robertson, Department of Agricultural Economics, Purdue University

10:08-10:18am

Discussion

10:18-10:33am

International trade in agricultural products at the U.S. state level (#7335)

- Edward J. Balistreri, University of Nebraska–Lincoln

10:33-10:43am

Discussion

10:43-10:45am

Session Closing

FRIDAY, JUNE 7

Presentation Schedule

Presenters should arrive to their assigned session room 10 minutes prior to the start of the session with their presentation on a USB drive in both PowerPoint and PDF formats. Times listed within each session are targets and may vary slightly.

**Looking for a paper?**

Search by ID# at: www.gtap.org/events/conferences/2024/

Time (MDT, UTC-6)	Event	Location
9:00-10:45am	Session #41	308

Food Systems

Session Chair: Ronald Sands, USDA Economic Research Service

9:00-9:03am Session Introduction

9:03-9:18am **Evaluating Environmental Clubs as a Strategy for Sustainable Food Systems: Practical alternative Pathway or Pie in the Sky?** (#7256)

– Etienne Berthet, Technical University of Denmark

9:18-9:28am Discussion

9:28-9:43am **Exploring Regional Heterogeneity in Food Systems Transformation: A Multi-Model Ensemble Perspective** (#7329)

– Thais Diniz Oliveira, Cornell University

9:43-9:53am Discussion

9:53-10:08am **Comparing food system sectoral changes in 2050 with historical transformations: A multi-model analysis** (#7313)

– Daniel Mason-D'Croz, Cornell University

10:08-10:18am Discussion

10:18-10:33am **Assessing the Individual and Cumulative Impacts of Drivers in Food Systems Transformation through a Multi-Model Ensemble Paradigm** (#7330)

– Marina Sundiang, Cornell University

10:33-10:43am Discussion

10:43-10:45am Session Closing

FRIDAY, JUNE 7

Presentation Schedule

Presenters should arrive to their assigned session room 10 minutes prior to the start of the session with their presentation on a USB drive in both PowerPoint and PDF formats. Times listed within each session are targets and may vary slightly.

**Looking for a paper?**

Search by ID# at: www.gtap.org/events/conferences/2024/

Time (MDT, UTC-6)	Event	Location
10:45-11:15am	Coffee Break	Ballroom B/C/D
11:15am-12:10pm	Organized Session #42	300

Climate Mitigation and Income Distribution: New Insights from the National, Regional and Global Studies

Organized by: Maksym Chepeliev, Center for Global Trade Analysis, Department of Agricultural Economics, Purdue University
Session Chair: Maksym Chepeliev, Center for Global Trade Analysis, Department of Agricultural Economics, Purdue University

11:15-11:18am	Session Introduction
11:18-11:33am	<u>Socio-economic implications of different options for a 2040 EU climate target</u> (#7306) — Matthias Weitzel, European Commission - Joint Research Centre
11:33-11:43am	Discussion
11:43-11:58am	<u>Assessing the Distributional Implications of Carbon Pricing Strategies for Mitigating Global Greenhouse Gas Emissions</u> (#7260) — Israel Osorio Rodarte, The World Bank
11:58am-12:08pm	Discussion
12:08-12:10pm	Session Closing

FRIDAY, JUNE 7

Presentation Schedule

Presenters should arrive to their assigned session room 10 minutes prior to the start of the session with their presentation on a USB drive in both PowerPoint and PDF formats. Times listed within each session are targets and may vary slightly.

**Looking for a paper?**

Search by ID# at: www.gtap.org/events/conferences/2024/

Time (MDT, UTC-6)	Event	Location
11:15am-12:35pm	Organized Session #43	302 (Longs Peak)

Advances in modeling the standard GTAP model in GAMS

Organized by: **Dominique van der Mensbrugge**, Center for Global Trade Analysis, Department of Agricultural Economics, Purdue University
Session Chair: **Dominique van der Mensbrugge**, Center for Global Trade Analysis, Department of Agricultural Economics, Purdue University

11:15-11:18am	Session Introduction
11:18-11:33am	<u>GTAPSim: A User-Friendly Interface for GTAP in GAMS</u> (#7173) – Lindsay Shutes, Freelance
11:33-11:43am	Discussion
11:43-11:58am	<u>Flexible nesting using standard GAMS</u> (#7174) – Dominique van der Mensbrugge , Center for Global Trade Analysis, Department of Agricultural Economics, Purdue University
11:58am-12:08pm	Discussion
12:08-12:23pm	<u>A Locally Flexible, Globally Regular Logit Cost Function</u> (#7351) – Thomas Rutherford , University of Wisconsin Madison
12:23-12:33pm	Discussion
12:33-12:35pm	Session Closing

FRIDAY, JUNE 7

Presentation Schedule

Presenters should arrive to their assigned session room 10 minutes prior to the start of the session with their presentation on a USB drive in both PowerPoint and PDF formats. Times listed within each session are targets and may vary slightly.

**Looking for a paper?**

Search by ID# at: www.gtap.org/events/conferences/2024/

Time (MDT, UTC-6)	Event	Location
11:15am-12:35pm	Organized Session #44	304

Re-thinking the way we model commodity trade flows

Organized by: **Thomas Hertel**, Center for Global Trade Analysis, Department of Agricultural Economics, Purdue University
Aline Mosnier, SDSN

Session Chair: **Thomas Hertel**, Center for Global Trade Analysis, Department of Agricultural Economics, Purdue University

11:15-11:18am Session Introduction

11:18-11:33am **Revisiting Commodity Trade Patterns Amidst Food System Shocks: Lessons from Structural Gravity with Counterfactual Experiments** (#7349)

– **Jason Grant**, Virginia Tech University

11:33-11:43am Discussion

11:43-11:58am **The impacts of polycrisis on global grain availability and prices** (#7171)

– **Aline Mosnier**, SDSN

11:58am-12:08pm Discussion

12:08-12:23pm **What if trade could enhance global sustainability? The SmartLinker Platform as a cooperative AI** (#7228)

– **Valeria Javalera**, International Institute for Applied Systems Analysis

12:23-12:33pm Discussion

12:33-12:35pm Session Closing

FRIDAY, JUNE 7

Presentation Schedule

Presenters should arrive to their assigned session room 10 minutes prior to the start of the session with their presentation on a USB drive in both PowerPoint and PDF formats. Times listed within each session are targets and may vary slightly.

**Looking for a paper?**

Search by ID# at: www.gtap.org/events/conferences/2024/

Time (MDT, UTC-6)	Event	Location
11:15am-12:35pm	Session #45	306

Carbon Border Adjustment Mechanisms

Session Chair: Jean Chateau, OECD Economics Department

11:15-11:18am Session Introduction

11:18-11:33am **Border Carbon Adjustments Revisited** (#7179)
– Christoph Böhringer, University of Oldenburg

11:33-11:43am Discussion

11:43-11:58am **The EU Carbon Border Adjustment Mechanism (CBAM): Implications for Indonesia** (#7338)
– Adinova Fauri, Centre for Strategic and International Studies Indonesia

11:58am-12:08pm Discussion

12:08-12:23pm **Green Transformation or Trade Protection? The Impact of Carbon Border Adjustment Mechanism on the Restructuring of Global Value Chains** (#7249)
– Wenqi Zhao, Beijing Forestry University

12:23-12:33pm Discussion

12:33-12:35pm Session Closing

FRIDAY, JUNE 7

Presentation Schedule

Presenters should arrive to their assigned session room 10 minutes prior to the start of the session with their presentation on a USB drive in both PowerPoint and PDF formats. Times listed within each session are targets and may vary slightly.

**Looking for a paper?**

Search by ID# at: www.gtap.org/events/conferences/2024/

Time (MDT, UTC-6)	Event	Location
11:15am-12:35pm	Session #46	308

Aluminium Use, Steelmaking in Climate Change Mitigation, And Fuel Usage in GE Modeling

Session Chair: Niven Winchester, Auckland University of Technology

11:15-11:18am Session Introduction

11:18-11:33am **Regional and sectoral disparities in global Aluminium use: Analysis of the global dynamic aluminium flows and footprints** (#7218)
– Zijie Ma, University College London

11:33-11:43am Discussion

11:43-11:58am **Role of Advanced Steelmaking Technologies in Global Climate Change Mitigation Scenarios** (#7259)
– Sergey Paltsev, MIT Joint Program on the Science and Policy of Global Change

11:58am-12:08pm Discussion

12:08-12:23pm **Representation of fuel usage in general equilibrium modeling** (#7196)
– Jonathan Siegle, Institute of Energy Economics and Rational Energy Use

12:23-12:33pm Discussion

12:33-12:35pm Session Closing

FRIDAY, JUNE 7

Presentation Schedule

Presenters should arrive to their assigned session room 10 minutes prior to the start of the session with their presentation on a USB drive in both PowerPoint and PDF formats. Times listed within each session are targets and may vary slightly.

**Looking for a paper?**

Search by ID# at: www.gtap.org/events/conferences/2024/

Time (MDT, UTC-6)	Event	Location
11:15am-12:35pm	Organized Session #47	312

The animal food sector's future: new results on emission demand, production, trade, and health outcomes

Organized by: Wusheng Yu, Department of Food and Resource Economics, Faculty of Science, University of Copenhagen
Session Chair: Wusheng Yu, Department of Food and Resource Economics, Faculty of Science, University of Copenhagen

11:15-11:18am	Session Introduction	
11:18-11:33am	<p><u>Assessing sectoral impacts of agrifood emission targets under alternative SSPs with improved substantiation of food demand and globalization patterns</u> (#7276)</p> <ul style="list-style-type: none"> – Wusheng Yu, Department of Food and Resource Economics, Faculty of Science, University of Copenhagen 	
11:33-11:43am	Discussion	
11:43-11:58am	<p><u>Carbon-taxation of food consumption: A global perspective</u> (#7195)</p> <ul style="list-style-type: none"> – Clara G. Bouyssou, University of Copenhagen 	
11:58am-12:08pm	Discussion	
12:08-12:23pm	<p><u>Potential impact of import shift from soybean to meat on China's food security</u> (#7170)</p> <ul style="list-style-type: none"> – Rongbo Wang, Jiangsu Ocean University 	
12:23-12:33pm	Discussion	
12:33-12:35pm	Session Closing	
12:35-1:50pm	Lunch	Ballroom B/C/D

FRIDAY, JUNE 7

Presentation Schedule

Presenters should arrive to their assigned session room 10 minutes prior to the start of the session with their presentation on a USB drive in both PowerPoint and PDF formats. Times listed within each session are targets and may vary slightly.

**Looking for a paper?**

Search by ID# at: www.gtap.org/events/conferences/2024/

Time (MDT, UTC-6)	Event	Location
1:50-3:35pm	Organized Session #48	300

The 4th Seminar on Bridging the Gap between CGE and NQTM: Spatial Competition, Spatial Risk, Anti-Granularity, and Clean Growth

Organized by: Anton Yang, Department of Economics, Yale University

Costas Arkolakis, Yale University

Session Chair: Samuel Kortum, Yale University

1:50-1:53pm Session Introduction

1:53-2:08pm **Spatial Competition and Market Power in China's Agricultural Markets** (#7268)

– Jianwei Ai, Renmin University of China

2:08-2:18pm Discussion

2:18-2:33pm **Anti-Granular Comparative Advantage** (#7207)

– Gary Lyn, Iowa State University

2:33-2:43pm Discussion

2:43-2:58pm **Mobile Money and the Geographic Span of Risk-Sharing** (#7267)

– Christina Qiu, Yale University

2:58-3:08pm Discussion

3:08-3:23pm **Clean Growth and Environmental Policies in the Global Economy** (#7147)

– Wei Xiang, Yale University

**Wallace E. Tyner Travel Funding Award Recipient*

3:23-3:33pm Discussion

3:33-3:35pm Session Closing

FRIDAY, JUNE 7

Presentation Schedule

Presenters should arrive to their assigned session room 10 minutes prior to the start of the session with their presentation on a USB drive in both PowerPoint and PDF formats. Times listed within each session are targets and may vary slightly.

**Looking for a paper?**

Search by ID# at: www.gtap.org/events/conferences/2024/

Time (MDT, UTC-6)	Event	Location
1:50-3:35pm	Organized Session #49	302 (Longs Peak)

Developments and Extensions in GTAP Modeling

Organized by: Zeynep Akgul, Center for Global Trade Analysis, Department of Agricultural Economics, Purdue University
 Erwin Corong, Center for Global Trade Analysis, Department of Agricultural Economics, Purdue University
Session Chair: Erwin Corong, Center for Global Trade Analysis, Department of Agricultural Economics, Purdue University

1:50-1:53pm	Session Introduction
1:53-2:08pm	<p><u>Modeling Savings and International Economic Flows in the GTAP Version 7 Model</u> (#7269)</p> <ul style="list-style-type: none"> – Maria Filipa Seara Pereira, Center for Global Trade Analysis, Department of Agricultural Economics, Purdue University
2:08-2:18pm	Discussion
2:18-2:33pm	<p><u>GTAP-HET Reloaded: An Integration of Firm Heterogeneity into the GTAP Version 7 Model</u> (#7274)</p> <ul style="list-style-type: none"> – Zeynep Akgul, Center for Global Trade Analysis, Department of Agricultural Economics, Purdue University
2:33-2:43pm	Discussion
2:43-2:58pm	<p><u>Incorporating Hydrogen as an Energy Source: An extension of GDyn-E model</u> (#7263)</p> <ul style="list-style-type: none"> – Ken Itakura, Nagoya City University
2:58-3:08pm	Discussion
3:08-3:23pm	<p><u>Quantity-based land allocation system: bringing realistic and consistent land allocation to the GTAP model</u> (#7301)</p> <ul style="list-style-type: none"> – Maros Ivanic, ERS-USDA
3:23-3:33pm	Discussion
3:33-3:35pm	Session Closing

FRIDAY, JUNE 7

Presentation Schedule

Presenters should arrive to their assigned session room 10 minutes prior to the start of the session with their presentation on a USB drive in both PowerPoint and PDF formats. Times listed within each session are targets and may vary slightly.

**Looking for a paper?**

Search by ID# at: www.gtap.org/events/conferences/2024/

Time (MDT, UTC-6)	Event	Location
1:50-3:10pm	Session #50	304

Pandemic and Conflict Assessments

Session Chair: Maksym Chepeliev, Center for Global Trade Analysis, Department of Agricultural Economics, Purdue University

1:50-1:53pm Session Introduction

1:53-2:08pm **Evaluating the welfare costs of the COVID-19 -pandemic in Finland with an AGE model of with Intergenerational Accounting** (#7290)

– Juha Honkatukia, National Institute for Health and Welfare

2:08-2:18pm Discussion

2:18-2:33pm **The Ukrainian Path to EU accession: An impact assessment** (#7282)

– Janine Pelikan, Thünen Institute of Market Analysis

2:33-2:43pm Discussion

2:43-2:58pm **Impact of ongoing conflict and pathways to recovery in Sudan: agricultural bounce-back, infrastructural investment and social protection** (#7146)

– James Thurlow, International Food Policy Research Institute

2:58-3:08pm Discussion

3:08-3:10pm Session Closing

FRIDAY, JUNE 7

Presentation Schedule

Presenters should arrive to their assigned session room 10 minutes prior to the start of the session with their presentation on a USB drive in both PowerPoint and PDF formats. Times listed within each session are targets and may vary slightly.

**Looking for a paper?**

Search by ID# at: www.gtap.org/events/conferences/2024/

Time (MDT, UTC-6)	Event	Location
1:50-3:35pm	Session #51	306

Supply Chains

Session Chair: Jingliang Xiao, Office of the Chief Economist, Global Affairs Canada

1:50-1:53pm Session Introduction

1:53-2:08pm **Modelling FDI in GTAP: Supply Chains Reconfiguration** (#7331)
– Shenjie Chen, Office of the Chief Economist, Global Affairs Canada

2:08-2:18pm Discussion

2:18-2:33pm **An Analysis of the US Ban on exports of Semiconductors and Supercomputers to Chinese firms: An Extended Supply Chain Analysis** (#7314)
– Terrie Walmsley, University of Southern California and ImpactECON

2:33-2:43pm Discussion

2:43-2:58pm **The European Union deforestation-free policy and the potential impacts on the Brazilian economy: the soy supply chain case** (#7181)
– Heloiza Stam, University of Sao Paulo

2:58-3:08pm Discussion

3:08-3:23pm **Harmonizing Horizons: Impact of Trade and Transport Reforms on Agrifood Value Chains in ECOWAS** (#7189)
– Abdallah Akintola, Data SPC/ Sultan Qaboos University

3:23-3:33pm Discussion

3:33-3:35pm Session Closing

FRIDAY, JUNE 7

Presentation Schedule

Presenters should arrive to their assigned session room 10 minutes prior to the start of the session with their presentation on a USB drive in both PowerPoint and PDF formats. Times listed within each session are targets and may vary slightly.

**Looking for a paper?**

Search by ID# at: www.gtap.org/events/conferences/2024/

Time (MDT, UTC-6)	Event	Location
1:50-3:10pm	Session #52	308
<i>Greenhouse Gas Emissions and Carbon Neutrality</i>		
Session Chair:	Angelo Gurgel , Massachusetts Institute of Technology	
1:50-1:53pm	Session Introduction	
1:53-2:08pm	<u>Assessing current climate-related policies impacts on GHGs emissions changes: a model linking strategy for Switzerland</u> (#7304) – Jean Chateau , OECD Economics Department	
2:08-2:18pm	Discussion	
2:18-2:33pm	<u>Reforming budgetary support to agriculture: GHG emission impacts, co-benefits and trade-offs</u> (#7315) – Hugo Valin , OECD	
2:33-2:43pm	Discussion	
2:43-2:58pm	<u>Health Impacts of Carbon Neutrality in China under Different Technology Pathways</u> (#7158) – Chenfei Qu , Institute of Energy, Environment and Economy, Tsinghua University	
2:58-3:08pm	Discussion	
3:08-3:10pm	Session Closing	
3:35-4:05pm	Coffee Break	Ballroom B/C/D

FRIDAY, JUNE 7

Presentation Schedule

Presenters should arrive to their assigned session room 10 minutes prior to the start of the session with their presentation on a USB drive in both PowerPoint and PDF formats. Times listed within each session are targets and may vary slightly.



Looking for a paper?

Search by ID# at: www.gtap.org/events/conferences/2024/

Time (MDT, UTC-6)	Event	Location
4:05-5:20pm	Plenary Session and Closing Remarks	Ballroom A

Optimal Unilateral Carbon Policy

Session Chair: Joseph Francois, University of Bern, World Trade Institute

4:05-4:10pm	Session Introduction
4:10-4:30pm	Optimal Unilateral Carbon Policy – Samuel Kortum, Yale University
4:30-4:50pm	Discussion
4:50-4:55pm	Session Closing
4:55-5:20pm	2025 Conference Preview and Closing Remarks – Dominique van der Mensbrugge, Center for Global Trade Analysis, Department of Agricultural Economics, Purdue University

ANNUAL CONFERENCE ON GLOBAL ECONOMIC ANALYSIS

SATURDAY, JUNE 8
Post-Conference Event

General Information

Those who registered and paid to participate in this event will enjoy a day-trip to Estes Park, Colorado, located at the eastern entrance of Rocky Mountain National Park. While in Estes Park, participants will be on their own to explore and enjoy the beautiful mountain town.



Schedule

Time	Details
7:00am	Arrive for check-in and boarding. Bustang stop  BUSTANG Southwest corner of Plum and Meridian Streets <i>Promptness is required as the bus will not wait for late arrivals.</i>
7:15am	Depart for Estes Park
8:20am	Arrive in Estes Park
8:20am-4:45pm	Participants on their own to explore
4:45pm	Meet back at bus for departure <i>Promptness is required as the bus will not wait for late arrivals.</i>
5:00pm	Depart for Fort Collins
6:05pm	Arrive in Fort Collins

Boarding Location
 Bustang stop  **BUSTANG**
 Southwest corner of Plum and Meridian Streets

Lory Student Center
 1101 Center Avenue Mall
 Fort Collins, Colorado 80521



28th Annual Conference on Global Economic Analysis



Kigali Convention Centre

Kigali, Rwanda

June 25-27, 2025



Global Trade Analysis Project

Center for Global Trade Analysis
Department of Agricultural Economics
Purdue University



United Nations
Economic Commission for Africa

Important Dates/Deadlines

Submissions	November 2024 – January 15, 2025
Abstract Review	mid-January – mid-February 2025
Status Notifications	late February 2025
Paper Submission	April 15, 2025

Contact

Ginger Batta (gbatta@purdue.edu)
Lead Program Manager, Center for Global Trade Analysis
Department of Agricultural Economics, Purdue University

SESSION PARTICIPANT INDEX

Session organizers, chairs, presenters, and discussants should locate their name below to determine the session(s) in which they are scheduled. Numbers represent page numbers in the program, from which, session date, time, and location can be identified.

Adenauer, Marcel.....	57
Aguiar, Angel.....	22, 58
Ahmad, Saad	22
Ai, Jianwei	66
Akgul, Zeynep.....	67
Akintola, Abdallah	69
Antimiani, Alessandro.....	28, 37
Arkolakis, Costas	66
Arndt, Channing	15, 48, 56
Arriola, Christine	25
Baldos, Uris Lantz	46
Balistreri, Edward J.	58
Barbier, Edward	48
Bartelings, Heleen	16
Becker, Jonathon	50
Bekkers, Eddy	43
Benavidez, Lauren	40
Berthet, Etienne.....	59
Beyene, Lulit Mitik.....	47
Bibas, Ruben.....	38
Böhringer, Christoph.....	63
Bouyssou, Clara G.....	65
Boysen, Ole.....	30, 51
Boysen-Urban, Kirsten	30, 39
Carrico, Caitlyn.....	37
Charlton, Diane	58
Chateau, Jean	63, 70
Chen, Shenjie.....	69
Chen, Shuo	24
Chen, Y.-H. Henry.....	17
Chepeliev, Maksym.....	16, 21, 38, 60, 68
Christensen, Martin Aaroe.....	47
Cicowiez, Martin	45
Cisneros-Pineda, Alfredo.....	15
Clora, Francesco.....	55
Corong, Erwin	34, 43, 49, 55, 67

SESSION PARTICIPANT INDEX

Session organizers, chairs, presenters, and discussants should locate their name below to determine the session(s) in which they are scheduled. Numbers represent page numbers in the program, from which, session date, time, and location can be identified.

Cortes Selva, Alma	17
Countryman, Amanda M.....	14, 35, 58
Creason, Jared.....	29
Cui, Hao (David).....	36
Dalheimer, Bernhard.....	30
Dawani, Chandni	18
Diallo, Mariam Amadou	39
Diniz Oliveira, Thais.....	59
Dixon, Janine	57
Dixon, Peter	25
Döbeling, Tatjana	23
dos Santos Fachinelli Ferrarini, Angel.....	20
El Baouchari, Nabil	41
Escalante, Luis	26
Fauri, Adinova.....	63
Ferreira-Filho, Joaquim Bento.....	24
Fox, Alan.....	34
Francois, Joseph.....	48, 71
Fraysse, Elizabeth	38
Galindev, Ragchaasuren.....	47
Gao, Ji	33
Gao, Xiang	33, 42
Garaffa, Rafael	32
Gatto, Alessandro	21
Gelatti, Elisagela	46
Gianetti, Giovanni William	24
Golub, Alla	35
Gonzalez Fischer, Carlos	38
Grant, Jason.....	62
Guepie, Geoffroy	19
Guimbard, Houssein.....	39
Gurgel, Angelo.....	32, 70
Hailesilassie, Mussie Mindaye	19
Haqiqi, Iman	15, 20
Hertel, Thomas	27, 48, 62
Hodges, Cedric	50

SESSION PARTICIPANT INDEX

Session organizers, chairs, presenters, and discussants should locate their name below to determine the session(s) in which they are scheduled. Numbers represent page numbers in the program, from which, session date, time, and location can be identified.

Honkatukia, Juha	68
Hsu, Shih-Hsun	17
Ikeme, Sionegael	18
Itakura, Ken	67
Ivanic, Maros	67
Jaiswal, Himanshu	28
Javalera, Valeria.....	62
Jensbye, Laerke	55
Johnson, Justin	41, 48
Kavallari, Aikaterini.....	32
Kharbouche, Ayoub.....	19
Khatir, Mustajab	57
Kim, Yong-Gun	22
Kortum, Samuel.....	66, 71
Kowalski, Przemyslaw	25
Leip, Debbora	51
Li, Shantong	33, 42
Lim, Byeong-ho	16
Lin, Kang	27
Liu, Jing	20
Liu, Xianglong Locky	41
Lofgren, Hans	45
Long, Ziyang.....	27
Lu, Yingying.....	46
Lyn, Gary.....	66
Ma, Zijie.....	64
Mahlkow, Hendrik	50
Mahrt, Kristi.....	26
Maliszewska, Maryla.....	34
Markusen, James	25
Martin, Will.....	45
Mason-D'Croz, Daniel.....	59
Matchaya, Greenwell	39
Menezes, Tais	35
Mevel, Simon.....	19
Minor, Peter.....	22

SESSION PARTICIPANT INDEX

Session organizers, chairs, presenters, and discussants should locate their name below to determine the session(s) in which they are scheduled. Numbers represent page numbers in the program, from which, session date, time, and location can be identified.

Mitaritonna, Maria Cristina	37
Moon, Jongwoo	32
Moore, Fran	14
Morris, Jennifer.....	17
Mosnier, Aline.....	62
Mukashov, Askar.....	56
Nilsson, Lars.....	37
Olekseyuk, Zoryana.....	23
Olivetti, Elsa.....	51
Osanya, Jessica	41
Osorio Rodarte, Israel.....	60
Paczos, Marta	36
Paltsev, Sergey	64
Pan, Chen	42
Pauw, Karl	26
Pei, Jiansuo.....	27, 33
Pelikan, Janine.....	68
Peng, Hantang.....	17
Peng, Xiujian	44
Pereira, Maria Filipa Seara	67
Peters, Ralf	49
Philippidis, George.....	18
Pradesha, Angga.....	30
Puangchit, Pattawee	49
Qi, Zike.....	36
Qiu, Christina	66
Qu, Chenfei	70
Ray, Srabashi	15, 46
Ren, Lifeng	29
Rimmer, Maureen.....	57
Robertson, Dewey.....	58
Robinson, Sherman.....	22
Rojas-Romagosa, Hugo.....	44
Rose, Adam.....	44
Rutherford, Thomas	61
Sall, Leysa Maty	19

SESSION PARTICIPANT INDEX

Session organizers, chairs, presenters, and discussants should locate their name below to determine the session(s) in which they are scheduled. Numbers represent page numbers in the program, from which, session date, time, and location can be identified.

Salvatici, Luca	28
Samyrao, Kisshor	36
Sands, Ronald	21, 59
Sanmang, Wu	33
Schreiber, Andrew	14, 20
Shakil, Golam Saroare	35
Shi, Lin	28
Shutes, Lindsay	61
Siegle, Jonathan	64
Simola, Antti	37
Simonato, Thiago	29
So, Yu Roger	43
Soroka, Natalie	23
Souza, Gessica	24, 29
Stam, Heloiza	69
Strutt, Anna	18
Suarez-Cuesta, David	34
Sun, Jiase	42
Sun, Yuanchen	33
Sundiang, Marina	59
Suzuki, Susumu	28
Taheripour, Farzad	24, 44
Takpara, Moukaila Mouzamilou	30
Tarr, David G.	32
Thierfelder, Karen	50
Thies, Annika	35
Thomas, Timothy	56
Thube, Sneha	40
Thurlow, James	26, 68
Valin, Hugo	40, 70
van der Mensbrugge, Dominique	14, 38, 61, 71
Vandyck, Toon	20
Villoria, Nelson B.	24
Vogt, Achim	23
Walmsley, Terrie	69
Wang, Ming	39

SESSION PARTICIPANT INDEX

Session organizers, chairs, presenters, and discussants should locate their name below to determine the session(s) in which they are scheduled. Numbers represent page numbers in the program, from which, session date, time, and location can be identified.

Wang, Rongbo	65
Wang, Xiaomei	18
Wang, Zhan	15
Watkins, Alex.....	41
Weitzel, Matthias.....	60
Winchester, Niven.....	40, 64
Wittwer, Glyn	22
Wolf, Rayan	45
Xia, Yan.....	42
Xiang, Wei	66
Xiao, Jingliang	69
Yang, Anton.....	27, 33, 42, 66
Yang, Cuihong	42
Yin, Ge	44
Yoo, Jeongho	16
You, Liangzhi.....	21
Yu, Wusheng	65
Yuan, Mei	36
Yuan, Wen Jin.....	34
Zhao, Wenqi	63
Zhao, Xin.....	21, 50
Zhao, Yu.....	27
Zheang, Chen.....	27
Zheng, Yu	51
Zhou, Lingling.....	40

ANNUAL CONFERENCE ON GLOBAL ECONOMIC ANALYSIS

PARTICIPANT LIST

Name	Affiliation	Country	Email
Adenauer, Marcel	OECD	France	marcel.adenauer@oecd.org
Aguiar, Angel	Center for Global Trade Analysis, Purdue University	United States	aaguiar@purdue.edu
Ahmad, Saad	US International Trade Commission	United States	saad.ahmad@usitc.gov
Ai, Jianwei	Renmin University of China	China	aijianwei@ruc.edu.cn
Akgul, Zeynep	Center for Global Trade Analysis, Purdue University	Türkiye	zakgul@purdue.edu
Akintola, Abdallah	Data SPC/ Sultan Qaboos University	Oman	abdallah.akintola@gmail.com
Antimiani, Alessandro	European Commission, DG TRADE	Belgium	alessandro.antimiani@ec.europa.eu
Arndt, Channing	International Food Policy Research Institute / CGIAR	United States	c.arndt@cgiar.org
Arriola, Christine	OECD	France	christine.arriola@oecd.org
Baldos, Uris Lantz	Center for Global Trade Analysis, Purdue University	United States	ubaldos@purdue.edu
Balistreri, Edward J.	University of Nebraska—Lincoln	United States	edward.balistreri@unl.edu
Barbier, Edward	Colorado State University	United States	edward.barbier@colostate.edu
Bartelings, Heleen	Wageningen Economic Research	The Netherlands	heleen.bartelings@wur.nl
Batan, Liaw	Nuseed	United States	liaw.batan@nuseed.com
Batta, Ginger	Center for Global Trade Analysis, Purdue University	United States	gbatta@purdue.edu
Becker, Jonathon	US EPA	United States	jon.m.becker@gmail.com
Bekkers, Eddy	World Trade Organization	Switzerland	eddybekkers@gmail.com
Belenkiy, Maksim	Department of Commerce	United States	maksim.belenkiy@trade.gov
Benavidez, Lauren	Center for Global Trade Analysis, Purdue University	United States	lbenavi@purdue.edu
Berthet, Etienne	Technical University of Denmark	Denmark	etber@dtu.dk
Beyene, Lulit Mitik	World Bank	United States	lbeyene@worldbank.org
Bibas, Ruben	OECD	France	ruben.bibas@oecd.org
Böhringer, Christoph	University of Oldenburg	Germany	boehringer@uni-oldenburg.de
Bouyssou, Clara G.	University of Copenhagen	Denmark	cgb@ifro.ku.dk
Boysen, Ole	European Commission, Joint Research Centre (JRC)	Spain	ole.boysen@ucd.ie
Boysen-Urban, Kirsten	University of Hohenheim	Germany	kirsten.urban@uni-hohenheim.de
Charlton, Diane	Montana State University	United States	diane.charlton@montana.edu
Chateau, Jean	OECD Economics Department	France	jean.chateau@oecd.org
Chemingui, Mohamed Abdelbasset	UN Economic and Social Commission for West Asia	Lebanon	cheminguim@un.org
Chen, Shenjie	Office of the Chief Economist, Global Affairs Canada	Canada	shenjie.chen@international.gc.ca
Chen, Shuo	Purdue University	United States	chen4371@purdue.edu
Chen, Y.-H. Henry	MIT Joint Program on the Science & Policy of Global Change	United States	chenyh@mit.edu
Chepeliev, Maksym	Center for Global Trade Analysis, Purdue University	United States	mchepeleli@purdue.edu

ANNUAL CONFERENCE ON GLOBAL ECONOMIC ANALYSIS

PARTICIPANT LIST

Name	Affiliation	Country	Email
Chouinard, Hayley	Colorado State University	United States	hayley.chouinard@colostate.edu
Christensen, Martin Aaroe	World Bank	United States	mchristensen1@worldbank.org
Cicowiez, Martin	CEDLAS-Universidad Nacional de La Plata	Argentina	martin@depeco.econo.unlp.edu.ar
Cisneros-Pineda, Alfredo	Center for Global Trade Analysis, Purdue University	United States	cisnero0@purdue.edu
Clora, Francesco	University of Copenhagen	Denmark	fc@ifro.ku.dk
Corong, Erwin	Center for Global Trade Analysis, Purdue University	United States	ecorong@purdue.edu
Cortes Selva, Alma	BMO	United States	alma.cortesselva@bmo.com
Countryman, Amanda M.	Colorado State University	United States	amanda.countryman@colostate.edu
Creason, Jared	US EPA	United States	creason.jared@epa.gov
Cui, Hao (David)	Wageningen Economic Research	The Netherlands	david.cui@wur.nl
Dalheimer, Bernhard	Purdue University	United States	bdalheim@purdue.edu
Dawani, Chandni	International College for Girls, The IIS University (India)	United States	c.dawani@gmail.com
Diallo, Mariam Amadou	Ghent University	Belgium	mariam29diallo@gmail.com
Diniz Oliveira, Thais	Cornell University	United States	thaisdiniz_oliveira@yahoo.com.br
Dixon, Janine	Centre of Policy Studies, Victoria University	Australia	janine.dixon@vu.edu.au
Dixon, Peter	Victoria University	Australia	peter.dixon@vu.edu.au
Döbeling, Tatjana	Thünen-Institut	Germany	tatjana.doebeling@thuenen.de
dos Santos Fachinelli Ferrarini, Angel	Federal University of Rondonopolis	Brazil	angel.ferrarini@ufr.edu.br
Driscoll, Avery	Colorado State University	United States	avery.driscoll@colostate.edu
El Baouchari, Nabil	Mohammed V University in Rabat	Morocco	nabil.elbaouchari@um5s.net.ma
Escalante Ochoa, Luis Enrique	IFPRI	United States	luisenrique.caritas@gmail.com
Fauri, Adinova	Centre for Strategic and International Studies Indonesia	Indonesia	adinova.fauri@csis.or.id
Febiandita, Sylvia	Centre for Strategic and International Studies	Indonesia	sylviafebiandita@gmail.com
Ferreira-Filho, Joaquim Bento	Escola Superior de Agricultura Luiz de Queiroz	Brazil	jbsferre@usp.br
Fox, Alan	US International Trade Commission (USITC)	United States	alan.fox@usitc.gov
Francois, Joseph	University of Bern, World Trade Institute	Switzerland	joseph.francois@gmail.com
Fraser, Ben	Department for Business & Trade	United Kingdom	benjamin.fraser2@businessandtrade.gov.uk
Fraysse, Elizabeth	Center for Global Trade Analysis, Purdue University	United States	efraysse@purdue.edu
Fulton, John	Sandia National Laboratories	United States	jdfulto@sandia.gov
Galindev, Ragchaasuren	World Bank	United States	ragchaasuren.galindev@gmail.com
Gao, Ji	China Energy Modeling Forum, Environmental Defense Fund	China	gaojj@cet.net.cn
Gao, Xiang	Chinese Academy of Sciences	China	gaoxiang@amss.ac.cn
Garaffa, Rafael	European Commission - JRC Seville	Spain	rafael.garaffa@ec.europa.eu

ANNUAL CONFERENCE ON GLOBAL ECONOMIC ANALYSIS

PARTICIPANT LIST

Name	Affiliation	Country	Email
Gatto, Alessandro	Wageningen University and Research	The Netherlands	alessandro.gatto@wur.nl
Gehlhar, Mark	Department of the Interior	United States	mgehlhar@osmre.gov
Gelatti, Elisagela	University Sao Paulo	Brazil	elisangelagelatti@hotmail.com
Gianetti, Giovanni William	Universidade de Sao Paulo	Brazil	giovani.gianetti@gmail.com
Golub, Alla	Center for Global Trade Analysis, Purdue University	United States	golub@purdue.edu
Gonzalez Fischer, Carlos	Cornell University	United States	cmg295@cornell.edu
Grant, Jason	Virginia Tech University	United States	jhgrant@vt.edu
Guepie, Geoffroy	Economic Commission for Africa	Ethiopia	gguepie@yahoo.fr
Guimbard, Houssein	CEPII	France	houssein.guimbard@cepii.fr
Gurgel, Angelo	Massachusetts Institute of Technology	United States	angelo_gurgel@yahoo.com.br
Hailesilassie, Mussie Mindaye	Messina University	Italy	hlsm86h06z315x@studenti.unime.it
Han, Kezi	China University of Political Science and Law	China	hankezi@cupl.edu.cn
Haqiqi, Iman	Center for Global Trade Analysis, Purdue University	United States	ihaqiqi@purdue.edu
Hertel, Thomas	Center for Global Trade Analysis, Purdue University	United States	hertel@purdue.edu
Hodges, Cedric	Deloitte Access Economics	Australia	cehodges@deloitte.com.au
Honkatukia, Juha	National Institute for Health and Welfare	Finland	juha.honkatukia@thl.fi
Hove, Privilage	Roma Tre University	Zimbabwe	hoveprivy11@gmail.com
Hsu, Shih-Hsun	National Taiwan University	Taiwan (ROC)	m577tony@gmail.com
Ikeme, Sionegael	Colorado State University	United States	sionegael.ikeme@colostate.edu
Itakura, Ken	Nagoya City University	Japan	itakura@econ.nagoya-cu.ac.jp
Ivanic, Maros	ERS-USDA	United States	ivanic@gmail.com
Jaiswal, Himanshu	IGIDR	India	himanshuj@igidr.ac.in
Javalera, Valeria	International Institute for Applied Systems Analysis	Austria	javalera@iiasa.ac.at
Jensbye, Laerke	University of Copenhagen	Denmark	lgj@ifro.ku.dk
Jerie, Michael	GEMPACK	Australia	michael.jerie@vu.edu.au
Johnson, Justin	University of Minnesota	United States	jandrewjohnson@gmail.com
Karingi, Stephen	United Nations Economic Commission for Africa (UNECA)	Ethiopia	karingi@un.org
Kavallari, Aikaterini	Food and Agriculture Organization of the United Nations	Italy	aikaterini.kavallari@fao.org
Kharbouche, Ayoub	Mohammed V University in Rabat	Morocco	ayoub.kharbouche@um5s.net.ma
Khatir, Mustajab	Birla Institute of Technology and Sciences - Hyderabad Campus	India	p20200505@hyderabad.bits-pilani.ac.in
Kim, Yong-Gun	Yonsei University	South Korea	ygkim6007@gmail.com
Kortum, Samuel	Yale University	United States	samuel.kortum@yale.edu
Kowalski, Przemyslaw	Organisation for Economic Co-operation & Development	France	przemyslaw.kowalski@oecd.org

ANNUAL CONFERENCE ON GLOBAL ECONOMIC ANALYSIS

PARTICIPANT LIST

Name	Affiliation	Country	Email
Kuo, Jeffrey	George Washington University	United States	jeffkuo@gwu.edu
Leip, Debhora	Potsdam Institute for Climate Impact Research	Germany	leip@pik-potsdam.de
Li, Shantong	Development Research Center of the State Council	China	lishantong333@126.com
Lim, Byeong-ho	Korea Maritime Institute	South Korea	bhlim@kmi.re.kr
Lin, Kang	Chinese Academy of Sciences	China	linkang96@amss.ac.cn
Liu, Jing	Center for Global Trade Analysis, Purdue University	United States	liu207@purdue.edu
Liu, Xianglong Locky	Centre of Policy Studies, Victoria University	Australia	locky.liu@vu.edu.au
Lofgren, Hans	[Independent Researcher]	United States	hanslofgren01@outlook.com
Long, Ziyang	Renmin University of China	China	ziyang_l@outlook.com
Lu, Yingying	CSIRO	Australia	lu_ying_ying@hotmail.com
Lyn, Gary	Iowa State University	United States	glyn@iastate.edu
Ma, Zijie	University College London	United Kingdom	zijie.ma.21@ucl.ac.uk
Mahlkow, Hendrik	Kiel Institute for the World Economy	Germany	hendrik.mahlkow@ifw-kiel.de
Mahrt, Kristi	International Food Policy Research Institute (IFPRI)	United States	k.mahrt@cgiar.org
Maliszewska, Maryla	The World Bank	United States	mmaliszewska@worldbank.org
Manning, Dale	Colorado State University	United States	dale.manning@colostate.edu
Markusen, James	University of Colorado, Boulder	United States	james.markusen@colorado.edu
Martin, Will	International Food Policy Research Institute (IFPRI)	United States	w.martin@cgiar.org
Mason-D'Croz, Daniel	Cornell University	United States	dem286@cornell.edu
Matchaya, Greenwell	IWMI	South Africa	g.matchaya@cgiar.org
McIntire, Holly	Center for Global Trade Analysis, Purdue University	United States	hcmcinti@purdue.edu
Menezes, Tais	Colorado State University	United States	tatacristinamenezes@hotmail.com
Mevel, Simon	United Nations Economic Commission for Africa	Ethiopia	mevel@un.org
Minor, Peter	ImpactECON	United States	peteminor@impactecon.com
Mitaritonna, Maria Cristina	CEPII	France	cristina.mitaritonna@cepii.fr
Moon, Jongwoo	Korea Environment Institute	South Korea	jwmoon@kei.re.kr
Moore, Fran	University of California Davis	United States	fmoore@ucdavis.edu
Morris, Jennifer	MIT	United States	holak@mit.edu
Mosnier, Aline	SDSN	France	aline.mosnier@unsdsn.org
Mukashov, Askar	IFPRI	United States	a.mukashov@cgiar.org
Nilsson, Lars	European Commission - DG Trade	Belgium	lars.nilsson@ec.europa.eu
Olekseyuk, Zoryana	German Institute of Development and Sustainability	Germany	zoryana.olekseyuk@idos-research.de
Olivetti, Elsa	FAO	Italy	olivetti.elsa@gmail.com

ANNUAL CONFERENCE ON GLOBAL ECONOMIC ANALYSIS

PARTICIPANT LIST

Name	Affiliation	Country	Email
Osanya, Jessica	Oregon State University	United States	osanyaj@oregonstate.edu
Osorio Rodarte, Israel	The World Bank	United States	iosoriorodarte@worldbank.org
Paczos, Marta	Department for Business & Trade	United Kingdom	marta.paczos@businessandtrade.gov.uk
Paltsev, Sergey	MIT Joint Program on the Science & Policy of Global Change	United States	paltsev@mit.edu
Pan, Chen	Chinese Academy of Social Sciences	China	chen_pan@outlook.com
Pauw, Karl	International Food Policy Research Institute (IFPRI)	United States	k.pauw@cgiar.org
Pei, Jiansuo	School of Applied Economics, Renmin University of China	China	jspei@ruc.edu.cn
Pelikan, Janine	Thünen Institute of Market Analysis	Germany	janine.pelikan@thuenen.de
Peng, Hantang	Tsinghua University	China	pht21@mails.tsinghua.edu.cn
Peng, Xiujian	Centre of Policy Studies, Victoria University	Australia	xiujian.peng@vu.edu.au
Pereira, Maria Filipa Seara	Center for Global Trade Analysis, Purdue University	United States	msearaep@purdue.edu
Peters, Ralf	United Nations Conference on Trade and Development	Switzerland	ralf.peters@unctad.org
Philippidis, George	CITA, Government of Aragón	Spain	gphilippidis@aragon.es
Pradesha, Angga	IFPRI	United States	pradesha.angga@gmail.com
Puangchit, Pattawee	Center for Global Trade Analysis, Purdue University	United States	ppuangch@purdue.edu
Qi, Zike	Peking University	China	qizike@pku.edu.cn
Qiu, Christina	Yale University	United States	christina.qiu@yale.edu
Qu, Chenfei	Tsinghua University	China	qcf20@mails.tsinghua.edu.cn
Ray, Srabashi	Center for Global Trade Analysis, Purdue University	United States	ray152@purdue.edu
Ren, Lifeng	University of Minnesota-Applied Economics	United States	ren00154@umn.edu
Rimmer, Maureen	Centre of Policy Studies	Australia	maureen.bleazby@vu.edu.au
Robertson, Dewey	Department of Agricultural Economics, Purdue University	United States	rober785@purdue.edu
Robinson, Sherman	International Food Policy Research Institute (IFPRI)	United States	s.robinson@cgiar.org
Rojas-Romagosa, Hugo	International Monetary Fund	United States	hrojas-romagosa@imf.org
Rose, Adam	University of Southern California	United States	adam.rose@usc.edu
Rutherford, Thomas	University of Wisconsin Madison	United States	rutherford@aae.wisc.edu
Sall, Leysa Maty	Bordeaux School of Economics and CEPII	France	leysa.maty.sall@gmail.com
Salvatici, Luca	Università Roma Tre	Italy	luca.salvatici@uniroma3.it
Samyrao, Kisshor	Department for Business & Trade	United Kingdom	kisshor.samyrao@businessandtrade.gov.uk
Sands, Ronald	USDA Economic Research Service	United States	ron.sands@usda.gov
Schmitz, Jan	European Commission - DG TRADE	Belgium	jan.schmitz@ec.europa.eu
Schreiber, Andrew	US Environmental Protection Agency (EPA)	United States	schreiber.andrew@epa.gov
Shakil, Golam Saroare	Washington State University	United States	golamsaroare.shakil@wsu.edu

ANNUAL CONFERENCE ON GLOBAL ECONOMIC ANALYSIS

PARTICIPANT LIST

Name	Affiliation	Country	Email
Shi, Lin	American University	United States	ls6953a@american.edu
Shutes, Lindsay	Freelance	United Kingdom	lindsayjshutes@gmail.com
Siegle, Jonathan	Institute of Energy Economics and Rational Energy Use	Germany	jonathan.siegle@ier.uni-stuttgart.de
Simola, Antti	European Commission - Joint Research Center	Spain	antti.simola@ec.europa.eu
Simonato, Thiago	Center for Global Trade Analysis, Purdue University	United States	tsimonat@purdue.edu
So, Yu Roger	Graduate Institute of International & Development Studies	Switzerland	rogeryu.so@wto.org
Soroka, Natalie	International Trade Administration	United States	natalie.soroka@trade.gov
Souza, Gessica	ENAP	Brazil	gessicacps@yahoo.com.br
Srikanth, Kavitha	Center for Global Trade Analysis, Purdue University	United States	ksrikan@purdue.edu
Stam, Heloiza	University of Sao Paulo	Brazil	heloiza.stam@gmail.com
Strutt, Anna	University of Waikato	New Zealand	astrutt@waikato.ac.nz
Suarez-Cuesta, David	Universidad Complutense de Madrid	Spain	dsuarez04@ucm.es
Sun, Jiase	Tsinghua University	China	sunjiase1991@126.com
Sun, Yuanchen	China University of Geosciences, Beijing	China	syc01999@163.com
Sundiang, Marina	Cornell University	United States	mms466@cornell.edu
Suzuki, Susumu	Economic and Social Research Institute, Cabinet Office	Japan	susumu.suzuki.j8b@cao.go.jp
Taheripour, Farzad	Department of Agricultural Economics, Purdue University	United States	tfarzad@purdue.edu
Takpara, Moukaila Mouzamilou	United Nations Economic Commission for Africa	Ethiopia	takpara2025@gmail.com
Tan, Ci	Hubei University Of Economics	China	tc2021haohao@163.com
Tarr, David G.	International School of Economics at TSU	United States	dgtarr@gmail.com
Thierfelder, Karen	USNA-ECONOMICS DEPT	United States	thier@usna.edu
Thies, Annika	Thuenen Institut	Germany	annika.thies@thuenen.de
Thomas, Timothy	International Food Policy Research Institute (IFPRI)	United States	tim.thomas@cgiar.org
Thube, Sneha	International Monetary Fund	United States	sthube@imf.org
Thurlow, James	International Food Policy Research Institute	United States	j.thurlow@cgiar.org
Valin, Hugo	OECD	France	hugo.valin@oecd.org
van der Mensbrugge, Dominique	Center for Global Trade Analysis, Purdue University	United States	vandermd@purdue.edu
Vandyck, Toon	OECD	France	toon.vandyck@oecd.org
Villoria, Nelson B.	Department of Agricultural Economics	United States	nvilloria@ksu.edu
Vogt, Achim	World Trade Institute, University Bern	Switzerland	achim.vogt@wti.org
Walmsley, Terrie	University of Southern California and ImpactECON	United States	twalmsle@usc.edu
Wang, Ming	Colorado State University	United States	wming@colostate.edu
Wang, Rongbo	Jiangsu Ocean University	China	rongbo0925@126.com

ANNUAL CONFERENCE ON GLOBAL ECONOMIC ANALYSIS

PARTICIPANT LIST

Name	Affiliation	Country	Email
Wang, Xiaomei	Shandong University	China	meiwang88@163.com
Wang, Zhan	Center for Global Trade Analysis, Purdue University	United States	zhanwang@purdue.edu
Watkins, Alex	University of Queensland	Australia	a.watkins@uq.edu.au
Weitzel, Matthias	European Commission - Joint Research Centre	Spain	matthias.weitzel@ec.europa.eu
Winchester, Niven	Auckland University of Technology	New Zealand	niven.winchester@aut.ac.nz
Wittwer, Glyn	Centre of Policy Studies	Australia	glyn.wittwer@vu.edu.au
Wolf, Rayan	Universidade Estadual de Mato Grosso do Sul	Brazil	rayanwolf@gmail.com
Xia, Yan	Institutes of Science and Development, CAS	China	xiayan@casipm.ac.cn
Xiang, Wei	Yale University	United States	weieconyale@gmail.com
Xiao, Jingliang	Office of the Chief Economist, Global Affairs Canada	Canada	jingliang.xiao@international.gc.ca
Yakhoub, Adoum Ali	Universite de Ndjamea	Chad	adoum_yakhoub@yahoo.fr
Yang, Anton	Department of Economics, Yale University	United States	anton.yang@yale.edu
Yang, Cuihong	Academy of Mathematics and Systems Science, CAS	China	chyang@iss.ac.cn
Yin, Ge	University College London	United Kingdom	ucbqgy0@ucl.ac.uk
Yoo, Jeongho	Pukyong National University	South Korea	jhyoo@pknu.ac.kr
You, Liangzhi	International Food Policy Research Institute	United States	l.you@cgiar.org
Yu, Wusheng	University of Copenhagen	Denmark	wusheng@ifro.ku.dk
Yuan, Mei	MIT Joint Program	United States	yuanmei@mit.edu
Yuan, Wen Jin	U.S. International Trade Commission	United States	wen.yuan@usitc.gov
Zhang, Da	Tsinghua University, China	China	zhangda1021@gmail.com
Zhang, Yibing	Capital University of Economics and Business	China	zhangyibing_0922@163.com
Zhao, Wenqi	Beijing Forestry University	China	zhaowq623@163.com
Zhao, Xin	Joint Global Change Research Institute, PNNL	United States	xin.zhao@pnnl.gov
Zhao, Yu	Chinese Academy of Sciences	China	zhaoyu2021@amss.ac.cn
Zheang, Chen	Renmin University of China	China	zheang_chen@ruc.edu.cn
Zheng, Yu	CEPII	France	yu.zheng@cepii.fr
Zhou, Lingling	China University of Geosciences Beijing	China	zhouling_zoe@163.com

GTAP UNIVERSITY (GTAP-U)

GTAP-U is the formal education initiative of the Global Trade Analysis Project (GTAP) and builds on the Center for Global Trade Analysis’ decades of teaching experience in the field of global economic analysis. The goal of GTAP-U is to expand access and improve educational and career opportunities for students and professionals, worldwide. GTAP-U offers courses on computable general equilibrium (CGE) modeling at the introductory, intermediate, and advanced levels, with specialized topics for in-depth policy analysis and advanced economic models. CGE models are widely used in the public and private sectors to inform strategic economic policy decisions—among the most prominent are trade, fiscal, and environmental policies. As such, they garner strong interest from national and international organizations, government agencies, consultancies, as well as research institutions. GTAP-U delivers high-quality theoretical and practical training in applied CGE modeling using the GTAP suite of models and data bases. Aimed towards building human capital in global economic analysis, GTAP-U courses help develop critical skills for independent economic research; connect individuals with diverse backgrounds and expertise across the globe; provide mentoring opportunities for training and capacity-building in institutions; and generate economic discussions that often lead to research opportunities in the global economic analysis community.

Course Catalog

❖ Introductory	GTAP 101 Course <i>Introduction to Computable General Equilibrium Modeling in the GTAP Framework</i>		Online 7 weeks
❖ Intermediate	GTAP Annual Short Course <i>Theory and Applications of Computable General Equilibrium Analysis with the GTAP Model</i>		Hybrid 8 weeks online + 5 days onsite
❖ Advanced	GTAP Dynamic Short Course <i>Applied General Equilibrium Analysis using a Dynamic Multi-Region Model</i>		Hybrid 6 weeks online + 5 days onsite
❖ Specialized	GTAP PTA Course <i>Applied Policy Analysis on Preferential Trade Agreements</i>	GTAP-HET Course <i>Applied Policy Analysis with Advanced Trade Models</i>	Online 6 weeks Online 7 weeks
❖ Interdisciplinary	SIMPLE-G Course <i>Multi-scale Analysis of Sustainability Issues Using the SIMPLE-G Model</i>		Hybrid 4 weeks online + 1 week onsite

Teaching Opportunities with GTAP-U



Calling all esteemed academicians and professionals in the field of economics!

.....

Are you interested in partnering with GTAP-U to develop and offer a course?

The Center for Global Trade Analysis is invites you to become part of GTAP-U!

From initial concept to polished delivery, GTAP-U’s streamlined course development process and comprehensive support will empower you to design engaging courses that reflect your unique teaching style, while harnessing the latest advancements in online learning. As a GTAP-U instructor, you will be part of a vibrant community of like-minded

professionals, engage in meaningful discussions, and collaborate with peers from around the globe.

More Information

For more information, please visit: www.gtap.org/events/gtap-u/.

“Advancing Applied General Equilibrium Modeling”

ISSN: 2377-2999

The *Journal of Global Economic Analysis* (JGEA):

- provides an open access, peer-reviewed platform for publication and dissemination of innovations in applied general equilibrium (AGE) modeling
- publishes developments in theory, data, statistical analysis, methods, and teaching
- enhances the credibility of AGE modeling by requiring replication of results during the peer-review process and, when possible, publication of new model code and data on the journal’s website
- builds on and extends the high-impact, peer-reviewed GTAP Technical Paper Series
- is ranked in the best quartile of Economics and Econometrics journals by major ranking agencies and is included in leading citation databases

The JGEA is ranked 58 out of 719 economics and econometrics journals in the Scimago Journal Rankings, 52 out of 705 journals in the Scopus rankings, and 68 out of 3042 periodicals in the Research Papers in Economics (RePEc) Simple Impact Factor Rankings.

Authors interested in submitting their work for publication, should consult the JGEA website for further details on focus, scope, and author guidelines.

Editors:

- **Thomas Hertel** (Purdue University)
- **Niven Winchester** (Auckland University of Technology)

Associate Editors:

- **Eddy Bekkers** (World Trade Organization)
- **Roberto Roson** (Ca' Foscari University of Venice & Loyola Andalusia University)
- **Anna Strutt** (University of Waikato)
- **Da Zhang** (Tsinghua University)

Editorial Advisory Board:

- | | |
|--|--|
| – Kym Anderson (Australian National University) | – David Hummels (Purdue University) |
| – Christoph Böhringer (University of Oldenburg) | – Sébastien Jean (CEPII) |
| – Peter Dixon (Victoria University) | – Kenichi Kawasaki (National Graduate Institute for Policy Studies) |
| – Thibault Fally (University of California-Berkeley) | – James Markusen (University of Colorado-Boulder) |
| – Karen Fisher-Vanden (Pennsylvania State University) | – Thomas Rutherford (University of Wisconsin-Madison) |
| – Joseph Francois (University of Bern) | – Jan van Heerden (University of Pretoria) |
| – Pinelopi Goldberg (Yale University) | – Tony Venables (University of Oxford) |
| – Eduardo Haddad (University of São Paulo) | |

More Information

For more information, please visit: www.jgea.org